



更多产品
请登入企业官网
进行查看
Enterprise official website

专注高端工业过程 控制阀解决方案

FOCUSING ON HIGH-END INDUSTRIAL
PROCESS CONTROL VALVE SOLUTIONS

非标定制阀门一站式解决方案

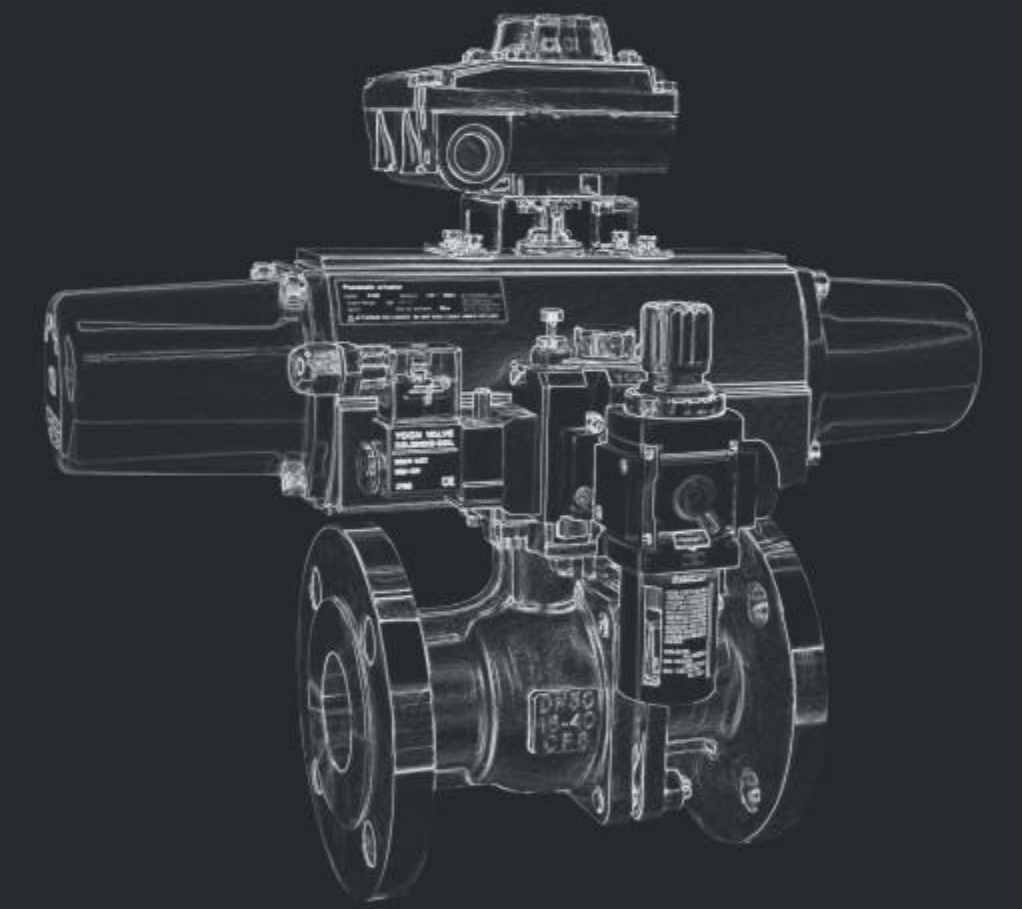

轶野控制阀门(上海)有限公司
YEAH CONTROL VALVE (SHANGHAI) CO., LTD.

销售中心: 上海市奉贤区南桥镇八字桥路1919号
全国统一热线: 021-67299258
邮箱: yeahvalve@163.com
企业官网: www.yeah-valve.com

Sales Center: No. 1919 Baziqiao Road, Nanqiao Town, Fengxian District, Shanghai
National Unified Hotline: 021-67299258
Email: yeahvalve@163.com
Enterprise official website: www.yeah-valve.com



轶野控制阀门(上海)有限公司
YEAH CONTROL VALVE (SHANGHAI) CO., LTD.

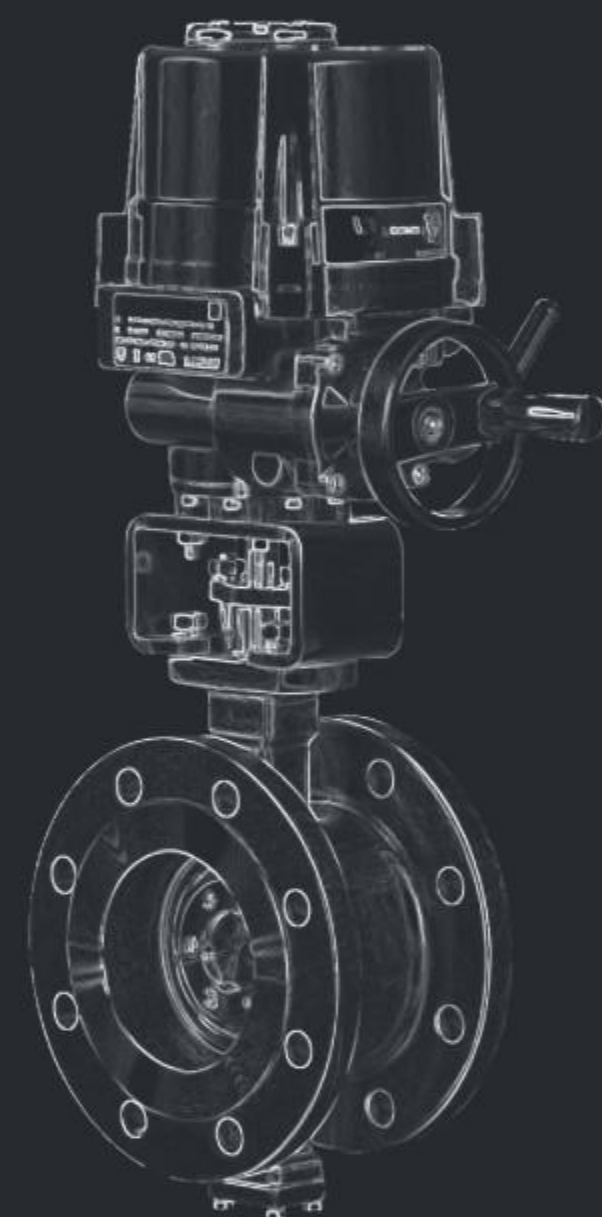

目录 / CATALOGUE

01-02	F15系列 两段式浮动球阀 法兰式、全口径 F15 series two section floating ball valve flange type, full bore
03-04	F20系列 两段式固定球阀 法兰式、全口径 F20 series two section frunnion mounted ball valve flange type, full bore
05-06	F25系列 多通道球阀 法兰式、全口径 F25 series multi-channel ball valve flange type, full bore
07-08	F30系列 超薄式球阀 法兰式、全口径 F30 series ultra-thin ball valve flange type, full bore
09-10	F35系列 V型固定球阀 对夹式、法兰式、全口径 F35 series V-shaped fixed ball valve clamp type, flange type, full bore
11-12	F50系列 三段式高温高压球阀 法兰式、全口径 F50 series three stage high-temperature and high-pressure ball valve flange type, full bore
13-14	F60系列 倾斜式放料球阀 法兰式、全口径 F60 series inclined discharge ball valve flange type, full bore
15-16	F45系列 双向流硬碰硬旋球阀 法兰式 F45 series bidirectional flow hard contact hard rotary ball valve flange type
17-18	F40系列 衬四氟球阀 法兰式、全口径 F40 series PTFE lined ball valve flange type, full bore
19-20	F55系列 三段式对焊/螺纹球阀 F55 series three stage butt welded/threaded ball valve
21-22	D40/41/42/43/44/45系列 高性能双偏心蝶阀 D40/41/42/43/44/45 series high-performance double eccentric butterfly valve
23-24	D50系列 三偏心对夹/法兰式蝶阀 D50 series three eccentric clamp/flange butterfly valve
25-26	D15系列 对夹式蝶阀 弹性阀座式 中线 D15 series clamp type butterfly valve with elastic seat center line
27-28	D20系列 法兰式蝶阀 弹性阀座式 中线 D20 series flange butterfly valve with elastic seat center line
29-30	AD/AS系列 拨叉式气动执行机构 AD/AS series fork type pneumatic actuator
31-32	RD/RS系列 齿轮齿条式气动执行机构 RD/RS series gear rack pneumatic actuator
33-36	APL-A系列 电动执行机构 非防爆式 APL-A series electric actuator non explosion proof type
37-43	APL-Q系列 电动执行机构 防爆式、非侵入式 APL-Q series electric actuator explosion-proof and non-invasive

F15系列 两段式浮动球阀 法兰式、全通径

F15 series two section floating ball valve flange type, full bore

轶野控制阀门(上海)有限公司
YEAH CONTROL VALVE (SHANGHAI) CO., LTD.

可选驱动配置 Optional driver configuration



概述及应用

F15系列结构简单,球体为浮动结构依靠介质作用在球体上的单项力,使球体向一侧的阀座靠拢。通过挤压阀座实现密封功能,主要应用于低压的切断场合。该系列阀门是作为管道开关使用的理想产品,它具有结构紧凑、重量轻、流通能力高、切断性能强、使用寿命长等特点。目前是蒸汽、烃类、腐蚀性介质等工况的最佳选择。

产品特点

- > 执行机构连接采用ISO5211国际标准
- > 全通径结构及锁定装置设计
- > 流通能力强、流阻小、双向密封
- > 阀杆防飞出结构、防火、防静电设计
- > 阀腔带自泄压
- > 阀座带有自洁功能
- > 可选多种执行机构

技术参数 Technical Parameters

公称通径 Nominal diameter	DN15~DN200(1/2"~8")
压力等级 Pressure grade	PN16 Class150 10K
工作温度 Operating temperature	-40°C~425°C
连接方式 Connection	法兰 Flange
密封形式 Sealing	RPTFE UHMWPE PEEK、全金属阀座
主要材质 Main materials	碳钢、不锈钢、特种合金 Carbon steel, stainless steel, and special alloy

Overview and Application

The F15 series features a simple structure. With a floating structure, the ball approaches a lateral seat by relying on the single force applied by the medium onto the ball. It can achieve sealing functions by extruding the seat. It is mainly applied to low-pressure shut-off scenarios. Such valves are perfect choices for pipeline switches, for they have apparent features, such as compact structure, low weight, high flow capacity, outstanding shut-off performance, and long service life. Currently, it is the best choice for the working conditions involving steam, hydrocarbon, and any corrosive mediums.

Product Features

- The international standard ISO5211 is adopted for the actuator;
- Full-bore structure and lock device design;
- Excellent flow capacity, small flow resistance, and two-way sealing;
- Stem anti-popping structure, fireproof and anti-static design;
- Cavity with self-pressure relief;
- Seat with self-cleaning function;
- Multiple actuators are optional.

产品认证 Product Certification

TUV IEC61508-SIL3安全完整性功能认证
TUV ISO15848低泄漏认证
TUV API607防火认证

TUV IEC61508-SIL3 Certification of safety and integrated functions
TUV ISO15848 Low-leakage certification
TUV API607 Fireproofing certification



可添加微信
了解更多产品与数据

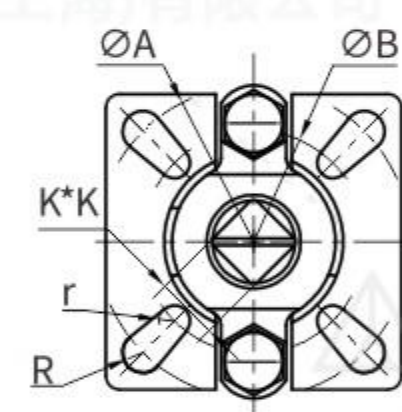
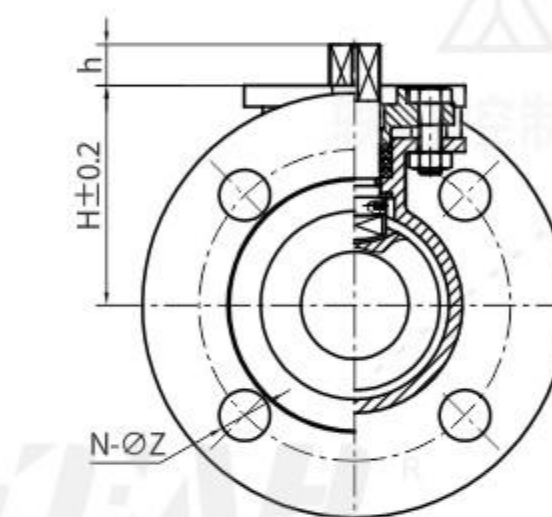
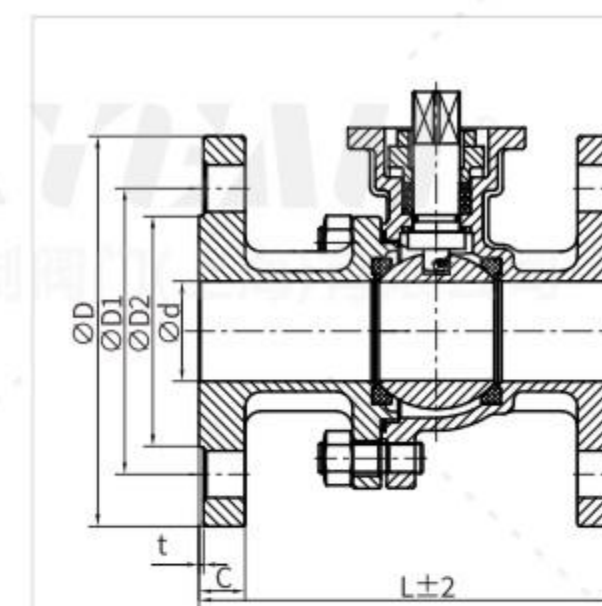

GB DN15-DN200-PN16

SIZE	d	D	D1	D2	C	t	L	H	A	B	R	r	K*K	h	N-Øz	Unit:mm
DN15	15	95	65	45	16	2	130	50	50	36	3.5	3	9*9	9	4-Ø14	
DN20	20	105	75	58	18	2	130	54	50	36	3.5	3	9*9	9	4-Ø14	
DN25	25	115	85	68	18	2	140	61	70	50	4.5	3.5	11*11	11	4-Ø14	
DN32	32	140	100	78	18	2	165	74	70	50	4.5	3.5	11*11	11	4-Ø18	
DN40	40	150	110	88	18	3	165	78	70	50	4.5	3.5	14*14	14	4-Ø18	
DN50	50	165	125	102	20	3	203	82	70	50	4.5	3.5	14*14	14	4-Ø18	
DN65	65	185	145	122	18	3	222	112	102	70	5.5	4.5	17*17	17	8-Ø18	
DN80	80	200	160	138	20	3	241	120	102	70	5.5	4.5	17*17	17	8-Ø18	
DN100	100	220	180	158	20	3	305	144	102	70	5.5	4.5	17*17	17	8-Ø18	
DN125	125	250	210	188	22	3	356	178	125	102	7	6	22	23	8-Ø18	
DN150	150	285	240	212	22	3	394	195	125	102	7	6	27	28	8-Ø22	
DN200	200	340	295	268	24	3	457	253	140	125	9	7	27	28	12-Ø22	

ASME 1/2"-8"-150LB

SIZE	d	D	D1	D2	C	t	L	H	A	B	R	r	K*K	h	N-Øz	Unit:mm
1/2"	15	90	60.5	35	10	2	108	51	50	36	3.5	3	9*9	9	4-Ø16	
3/4"	20	100	70	43	11	2	117	56	50	36	3.5	3	9*9	9	4-Ø16	
1"	25	110	79.5	51	12	2	127	62	70	50	4.5	3.5	11*11	11	4-Ø16	
1 1/4"	32	115	89	63.5	13	2	140	72	70	50	4.5	3.5	11*11	11	4-Ø16	
1 1/2"	40	125	98.5	73	15	2	165	78	70	50	4.5	3.5	14*14	14	4-Ø16	
2"	50	150	120.5	92	17	2	178	86	70	50	4.5	3.5	14*14	14	4-Ø19	
2 1/2"	65	180	140	105	18	2	190	102	102	70	5.5	4.5	17*17	17	4-Ø19	
3"	80	190	152.5	127	20	2	203	115	102	70	5.5	4.5	17*17	17	4-Ø19	
4"	100	230	190.5	157	24	2	229	137	102	70	5.5	4.5	17*17	17	8-Ø19	
5"	125	255	216	186	24	2	356	175	125	102	7	6	22	23	8-Ø22	
6"	150	280	241.5	216	26	2	394	208	125	102	7	6	27	28	8-Ø22	
8"	200	345	298.5	267	29	2	457	252	140	125	9	7	27	28	8-Ø22	

JIS 15A-200A-10K

SIZE	d	D	D1	D2	C	t	L	H	A	B	R	r	K*K	h	N-Øz	Unit:mm
15A	15	95	70	51	12	1	108	51	50	36	3.5	3	9*9	9	4-Ø15	
20A	20	100	75	56	14	1	117	56	50	36	3.5	3	9*9	9	4-Ø15	
25A	25	125	90	67	14	1	127	62	50	42	3.5	3	11*11	11	4-Ø19	
32A	32	135	100	76	16	2	140	72	50	42	3.5	3	11*11	11	4-Ø19	
40A	40	140	105	81	16	2	165	78	70	50	4.5	3.5	14*14	14	4-Ø19	
50A	50	155	120	96	16	2	178	86	70	50	4.5	3.5	14*14	14	4-Ø19	
65A	65	175	140	116	18	2	190	102	102	70	5.5	4.5	17*17	17	4-Ø19	
80A	80	185	150	126	18	2	203	115	102	70	5.5	4.5	17*17	17	8-Ø19	
100A	100	210	175	151	18	2	229	137	102	70	5.5	4.5	17*17	17	8-Ø19	
125A	125	250	210	185	20	2	356	175	125	102	7	6	22	23	8-Ø23	
150A	150	280	240	215	22	2	394	208	125	102	7	6	27	28	8-Ø23	
200A	200	330	290	265	22	2	457	252	140	125	9	7	27	28	12-Ø23	

DIN DN15-DN200-PN16

SIZE	d	D	D1	D2	C	t	L	H	A	B	R	r	K*K	h	N-Øz	Unit:mm
DN15	15	95	65	45	16	2	115	55	50	36	3.5	3	9*9	9	4-Ø14	
DN20	20	105	75	58	18	2	120	60	50	36	3.5	3	9*9	9	4-Ø14	
DN25	25	115	85	68	18	2	125	67	70	50	4.5	3.5	11*11	11	4-Ø14	
DN32	32	140	100	78	18	2	130	76	70	50	4.5	3.5	11*11	11	4-Ø18	
DN40	40	150	110	88	18	3	140	85	70	50	4.5	3.5	14*14	14	4-Ø18	
DN50	50	165	125	102	18	3	150	93	70	50	4.5	3.5	14*14	14	4-Ø18	
DN65	65	185	145	122	18	3	170	113	102	70	5.5	4.5	17*17	17	8-Ø18	
DN80	80	200	160	138	20	3	180	126	102	70	5.5	4.5	17*17	17	8-Ø18	
DN100	100	220	180	158	20	3	190	141	102	70	5.5	4.5	17*17	17	8-Ø18	
DN125	125	250	210	188	22	3	325	180	125	102	7	6	22	23	8-Ø18	
DN150	150	285	240	212	22	3	350	207	125	102	7	6	27	27	8-Ø22	
DN200	200	340	295	268	24	3	400	256	140	125	9	7	36	36	12-Ø22	

F20系列 两段式固定球阀 法兰式、全通径

F20 series two section frunnion mounted ball valve flange type, full bore

轶野控制阀门(上海)有限公司
YEAH CONTROL VALVE (SHANGHAI) CO., LTD.

可选驱动配置 Optional driver configuration



可大扭矩气动操作
Capable of high torque
pneumatic operation



可大扭矩电动操作
Capable of high torque
electric operation



可气动操作
Operable pneumatic



可电动操作
Operable electrically

概述及应用

F20系列固定球阀，消化吸收最新国际技术开发出的适合于化工、石化、耐腐蚀等工况的高性能软密封/硬密封球阀产品，可以适应高压和大口径场合，广泛应用于石油、化工、天然气、电力、冶金、食品等行业。

Overview and Application

The F20 Series trunnion mounted ball valve is a high-performance soft seal/hard seal ball valve product developed by digesting and absorbing the latest international technology, suitable for chemical, petrochemical, corrosion-resistant and other working conditions. It can adapt to high-pressure and large-diameter applications and is widely used in industries such as petroleum, chemical, natural gas, power, metallurgy, and food.

产品特点

- > 执行机构连接采用ISO5211国际标准
- > 全通径结构及锁定装置设计
- > 流通能力强、流阻小、双向密封
- > 阀杆防飞出结构、防火、防静电设计
- > 阀腔带自泄压
- > 阀座带有自洁功能
- > 可选多种执行机构

Product Features

- The international standard ISO5211 is adopted for the actuator;
- Full-bore structure and lock device design;
- Excellent flow capacity, small flow resistance, and two-way sealing;
- Stem anti-popping structure, fireproof and anti-static design;
- Cavity with self-pressure relief;
- Seat with self-cleaning function;
- Multiple actuators are optional.

技术参数 Technical Parameters

公称通径 Nominal diameter	DN200~DN600(8"~24")
压力等级 Pressure grade	PN16~PN25 Class150~Class300
工作温度 Operating temperature	-40°C~425°C
连接方式 Connection	法兰 Flange
密封形式 Sealing	RPTFE UHMWPE PEEK、全金属阀座
主要材质 Main materials	碳钢、不锈钢、特种合金 Carbon steel, stainless steel, and special alloy

产品认证 Product Certification

TUV IEC61508-SIL3安全完整性功能认证
TUV ISO15848低泄漏认证
TUV API607防火认证

TUV IEC61508-SIL3 Certification of safety and integrated functions
TUV ISO15848 Low-leakage certification
TUV API607 Fireproofing certification



可添加微信
了解更多产品与数据

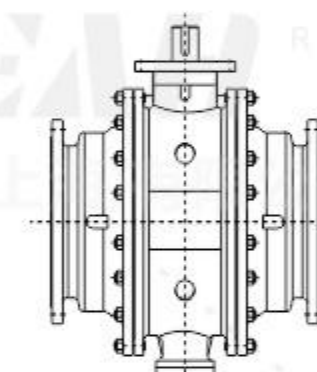
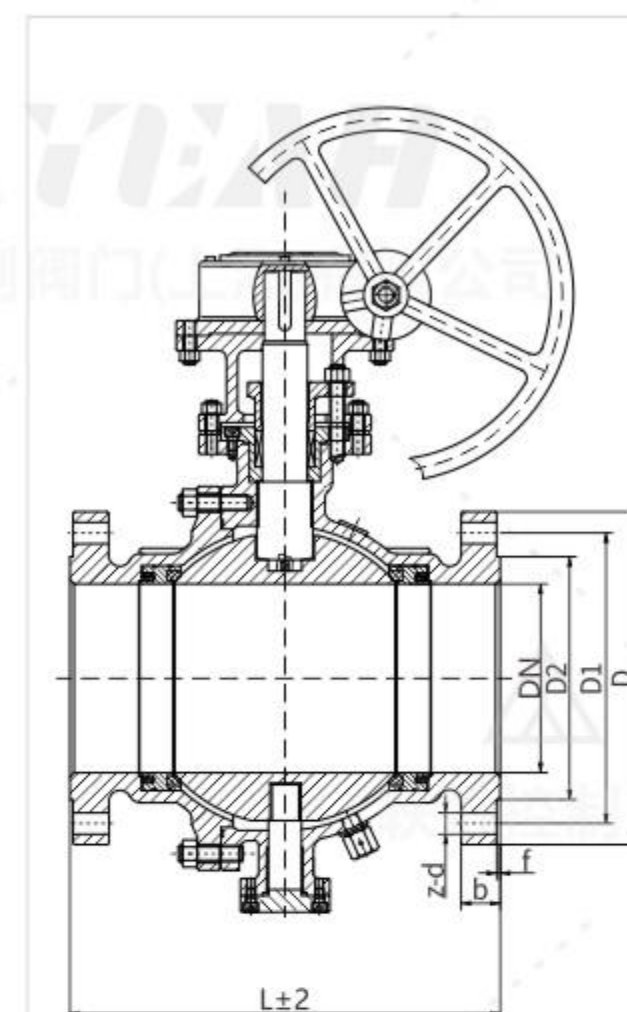

DN400-DN600 三段式结构
16"-24" Three-stage structure



GB DN200-DN600-PN16

DN	L	D	D1	D2	b	f	z-Φd
200	400/457	340	295	268	24	3	12-Φ22
250	533	405	355	320	26	3	12-Φ26
300	610	460	410	678	28	3	12-Φ26
350	686	520	471	438	30	3	16-Φ26
400	726	580	525	490	32	3	16-Φ30
450	864	640	585	550	40	3	20-Φ30
500	914	715	650	610	44	3	20-Φ33
600	1067	840	770	725	54	3	20-Φ36

GB DN200-DN600-PN25

DN	L	D	D1	D2	b	f	z-Φd
200	502	360	310	278	34	3	12-Φ25
250	568	425	370	332	36	3	12-Φ30
300	648	485	430	390	40	4	16-Φ30
350	762	550	490	480	44	4	16-Φ34
400	838	610	550	505	48	4	16-Φ34
450	864	660	600	555	50	4	20-Φ34
500	991	730	660	610	52	4	20-Φ41
600	1067	840	770	718	56	5	20-Φ41

ASME 8"-24"-150LB

SIZE	L	D	D1	D2	b	f	z-Φd
8"	457	343	298.5	270	29	1.6	8-Φ22
10"	533	406	362	324	31	1.6	12-Φ25
12"	610	483	432	381	32	1.6	12-Φ25
14"	686	533	476	413	35	1.6	12-Φ29
16"	762	597	540	470	37	1.6	16-Φ29
18"	864	635	578	533	40	1.6	16-Φ32
20"	914	699	635	584	43	1.6	20-Φ32
24"	1067	813	749.5	692	48	1.6	20-Φ35

ASME 8"-24"-300LB

SIZE	L	D	D1	D2	b	f	z-Φd
8"	502	381	330	270	41.5	1.6	12-Φ25
10"	568	445	387.5	324	48	1.6	16-Φ29
12"	648	521	451	381	51	1.6	16-Φ32
14"	762	584	514.5	413	54	1.6	20-Φ32
16"	838	648	571.5	470	58	1.6	20-Φ35
18"	914	711	628.5	533	61	1.6	24-Φ35
20"	991	775	686	584	64	1.6	24-Φ35
24"	1143	914	813	692	70	1.6	24-Φ41

F25系列 多通道球阀 法兰式、全口径

F25 series multi-channel ball valve flange type, full bore

轶野控制阀门(上海)有限公司
YEAH CONTROL VALVE (SHANGHAI) CO., LTD.

可选驱动配置 Optional driver configuration



可手动操作
Operable manually



可蜗轮操作
Operable worm gear



可气动操作
Operable pneumatic



可电动操作
Operable electrically

概述及应用

F25系列三通T型、L型球阀，四阀座结构。广泛应用于石油、化工、天然气、电力、冶金、食品以及处理等行业，主要用于换向、合流、分流等工况。

产品特点

- > 执行机构连接采用ISO5211国际标准
- > 全口径结构及锁定装置设计
- > 流通能力强、流阻小、双向密封
- > 阀杆防飞出结构、防火、防静电设计
- > 阀腔带自泄压
- > 阀座带有自洁功能
- > 可选多种执行机构

技术参数 Technical Parameters

公称口径 Nominal diameter	DN15~DN200(1/2"~8")
压力等级 Pressure grade	PN16 Class150 10K
工作温度 Operating temperature	-40°C~425°C
连接方式 Connection	法兰 Flange
密封形式 Sealing	RPTFE UHMWPE PEEK、全金属阀座
流道形式 Flow	T型、L型、Y型 T-type,L-type,Y-type
主要材质 Main materials	碳钢、不锈钢、特种合金 Carbon steel, stainless steel, and special alloy

Overview and Application

The F25 series three-way T-type valve,L-type valve, and four-seat structure. Extensively applied to petroleum, chemical engineering, natural gas, electric power, metallurgy, food, treatment, and other industries for the working conditions including reversing, confluence, and diversion.

Product Features

- The international standard ISO5211 is adopted for the actuator;
- Full-bore structure and lock device design;
- Excellent flow capacity, small flow resistance, and two-way sealing;
- Stem anti-popping structure, fireproof and anti-static design;
- Cavity with self-pressure relief;
- Seat with self-cleaning function;
- Multiple actuators are optional.

产品认证 Product Certification

TUV IEC61508-SIL3安全完整性功能认证
TUV ISO15848低泄漏认证
TUV API607防火认证

TUV IEC61508-SIL3 Certification of safety and integrated functions
TUV ISO15848 Low-leakage certification
TUV API607 Fireproofing certification



可添加微信
了解更多产品与数据

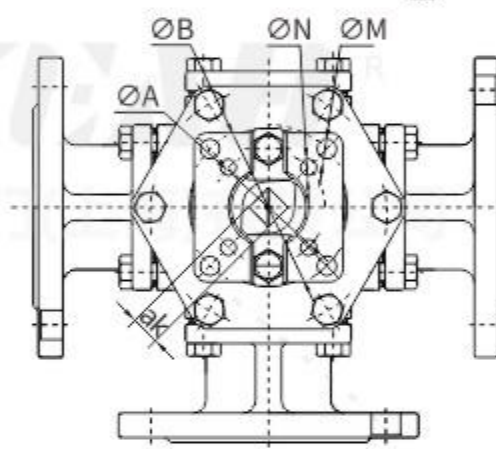
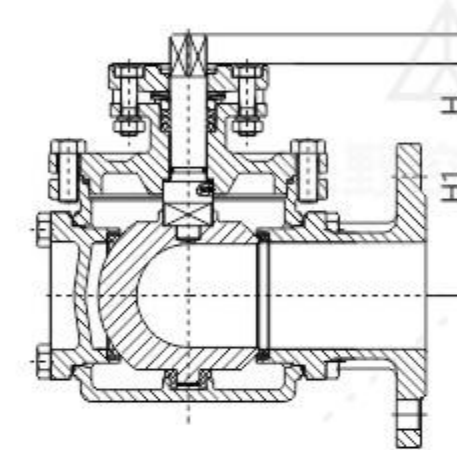
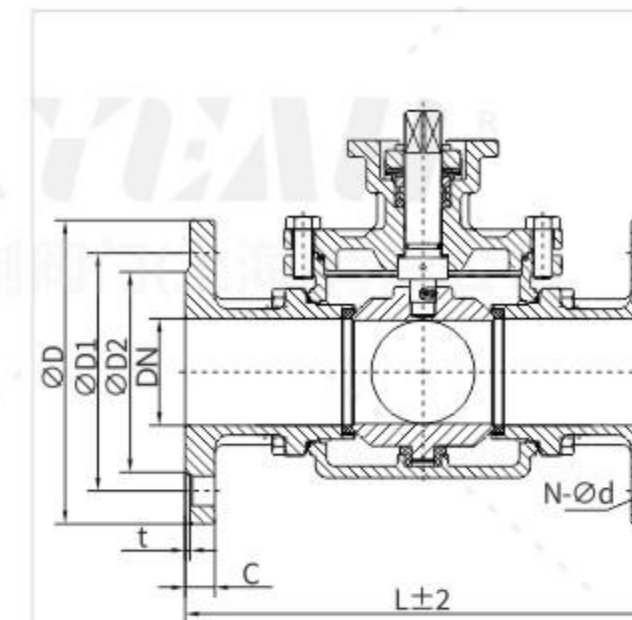

3-Way L-Port

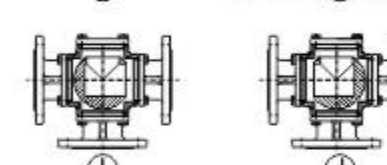
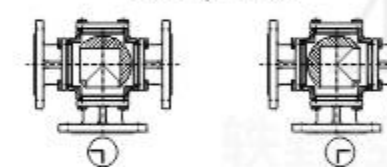

3-Way T-Port

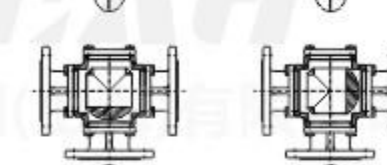
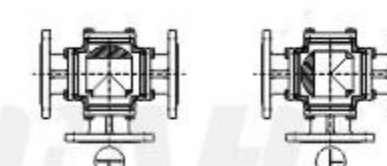

4-Way X-Port

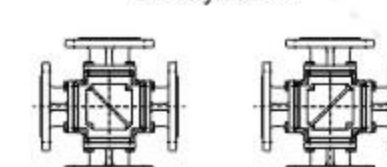

GB DN15-DN50-PN16

SIZE	DN	L	D	D1	D2	t	C	N-Ød	H	H1	aK	A	B	M	N
DN15	15	152	95	65	45	2	16	4-Ø14	11	44	9	42	36	3	3
DN20	20	167	105	75	55	2	18	4-Ø14	11	56.5	9	50	42	3.5	3
DN25	25	190	115	85	65	2	18	4-Ø14	11	64	11	50	42	3.5	3
DN32	32	208	140	100	78	2	18	4-Ø18	14	78	11	70	50	4.5	3.5
DN40	38	230	150	110	85	3	18	4-Ø18	14	96	14	102	70	6	5
DN50	50	254	165	125	100	3	20	4-Ø18	14	100	14	102	70	6	5

ASME 1/2"-2"-150LB

SIZE	DN	L	D	D1	D2	t	C	N-Ød	H	H1	aK	A	B	M	N
1/2"	15	152	90	60.5	35	2	10	4-Ø16	11	44	9	42	36	3	3
3/4"	20	167	100	70	43	2	11	4-Ø16	11	56.5	9	50	42	3.5	3
1"	25	190	110	79.5	51	2	12	4-Ø16	11	64	11	50	42	3.5	3
1¼"	32	208	115	89	63.5	2	13	4-Ø16	14	78	11	70	50	4.5	3.5
1½"	38	230	125	98.5	73	2	15	4-Ø16	14	96	14	102	70	6	5
2"	50	254	150	120.5	92	2	16	4-Ø19	14	100	14	102	70	6	5

JIS 15A-50A-10K

SIZE	DN	L	D	D1	D2	t	C	N-Ød	H	H1	aK	A	B	M	N
15A	15	152	95	70	52	1	12	4-Ø15	11	44	9	42	36	3	3
20A	20	167	100	75	58	1	14	4-Ø15	11	56.5	9	50	42	3.5	3
25A	25	190	125	90	70	1	14	4-Ø19	11	64	11	50	42	3.5	3
32A	32	208	135	100	80	2	16	4-Ø19	14	78	11	70	50	4.5	3.5
40A	38	230	140	105	85	2	16	4-Ø19	14	96	14	102	70	6	5
50A	50	257	155	120	100	2	16	4-Ø19	14	100	14	102	70	6	5

GB/ASME

SIZE	DN	L	D	D1	D2	t	C	N-Ød	H	H1	aK	A	B	M	N
2½"	65	275	185	145	122	3	18	4-Ø18	17	124	17	102	70	11	9
3"	80	300	200	160	138	3	20	8-Ø18	23	155	22	125	102	14	12
4"	100	345	220	180	158	3	20	8-Ø18	23	178	22	125	102	14	12
5"	122	420	250	210	188	3	22	8-Ø18	23	203	22	125	102	14	12
6"	147	510	285	240	212	3	22	8-Ø22	37	260	36	140	125	22	18
8"	197	630	340	295	268	3	24	8-Ø22	37	310	36	140	125	22	18

F30系列 超薄式球阀 法兰式、全口径

F30 series ultra-thin ball valve flange type, full bore

轶野控制阀门(上海)有限公司
YEAH CONTROL VALVE (SHANGHAI) CO., LTD.

可选驱动配置 Optional driver configuration



可手动操作
Operable manually



可蜗轮操作
Operable worm gear



可气动操作
Operable pneumatic



可电动操作
Operable electrically

概述及应用

F30系列高平台对夹球阀,法兰采用螺纹连接方式,此款产品具有结构长度短重量轻、安装方便等特点。适用于空间狭小,高空操作安装困难等工况全口径设计,减少流道空阻力便于流量控制,该产品还可提供线性流道口V型流道口等。

Overview and Application

The F30 series high platform clamp ball valve adopts a threaded connection method for the flange. This product has the characteristics of short structural length, light weight, and easy installation. Suitable for working conditions such as limited space and difficulty in high-altitude operation and installation, this product features a full bore design to reduce channel air resistance and facilitate flow control. It can also provide linear channel ports, V-shaped channel ports, etc.

产品特点

- > 执行机构连接采用ISO5211国际标准
- > 全口径结构及锁定装置设计
- > 流通能力强、流阻小、双向密封
- > 阀杆防飞出结构、防火、防静电设计
- > 阀腔带自泄压
- > 阀座带有自洁功能
- > 可选多种执行机构

Product Features

- The international standard ISO5211 is adopted for the actuator;
- Full-bore structure and lock device design;
- Excellent flow capacity, small flow resistance, and two-way sealing;
- Stem anti-popping structure, fireproof and anti-static design;
- Cavity with self-pressure relief;
- Seat with self-cleaning function;
- Multiple actuators are optional.

技术参数 Technical Parameters

公称口径 Nominal diameter	DN15~DN125(1/2"~5")
压力等级 Pressure grade	PN10~PN40
工作温度 Operating temperature	-40°C~425°C
连接方式 Connection	法兰 Flange
密封形式 Sealing	RPTFE UHMWPE PEEK
主要材质 Main materials	碳钢、不锈钢、特种合金 Carbon steel, stainless steel, and special alloy

产品认证 Product Certification

TUV IEC61508-SIL3安全完整性功能认证
TUV ISO15848低泄漏认证
TUV API607防火认证

TUV IEC61508-SIL3 Certification of safety and integrated functions
TUV ISO15848 Low-leakage certification
TUV API607 Fireproofing certification



可添加微信
了解更多产品与数据

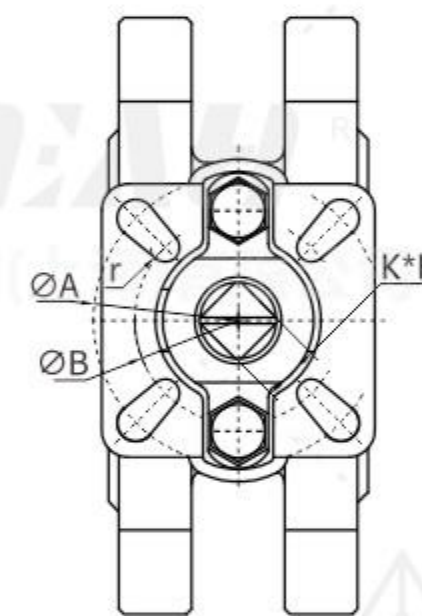
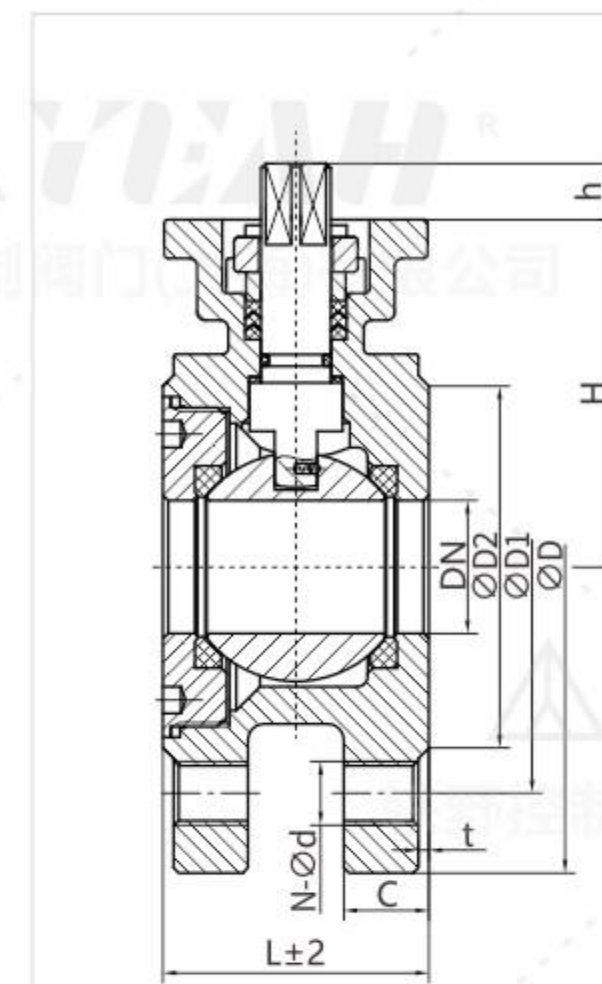

GB DN15-DN50 PN16-PN40 DN65-DN125 PN16

DN	PN	D	D1	D2	L	N-φd	C	t	H	h	K*K	B	A
DN15	16-40	95	65	45	44	4-M12	14	2	62	9	9	36	50
DN20	16-40	105	75	58	44	4-M12	16	2	62	9	9	36	50
DN25	16-40	115	85	68	50	4-M12	16	2	68	11	11	42	50
DN32	16-40	140	100	78	60	4-M16	18	2	79	11	11	42	50
DN40	16-40	150	110	88	65	4-M16	18	2	86	14	14	50	70
DN50	16-40	165	125	102	80	4-M16	20	2	87	14	14	50	70
DN65	16	185	145	122	110	4-M16	18	3	114	17	17	70	102
DN80	16	200	160	138	120	8-M16	20	3	133	17	17	70	102
DN100	16	220	180	158	152	8-M16	20	3	140	17	17	70	102
DN125	16	250	210	188	180	8-M16	22	3	171	22	22	102	125

GB DN65-DN125 PN25-PN40

DN	PN	D	D1	D2	L	N-φd	C	t	H	h	K*K	B	A
DN65	25-40	185	145	122	110	8-M16	22	3	116	17	17	70	102
DN80	25-40	200	160	138	120	8-M16	24	3	133	17	17	70	102
DN100	25-40	235	190	162	152	8-M20	24	3	146	17	17	70	102
DN125	25-40	270	220	188	180	8-M24	26	3	171	22	22	102	125

超薄式球阀CV值

SIZE	DN	开度 Opening					
		20%	30%	50%	70%	80%	100%
1/2"	DN15	0.2	0.7	2.4	8.9	12.3	18
3/4"	DN20	0.5	1.6	5.2	17.6	25.5	36
1"	DN25	0.9	2.2	7.2	23.8	32.9	48
1-1/4"	DN32	1.5	3.9	13.5	46.5	70.7	93
1-1/2"	DN40	2.6	6.7	23.6	83.4	120.3	165
2"	DN50	4.6	9.2	29.5	104.0	156.0	207
2-1/2"	DN65	7.8	20.5	65.8	216.3	330.1	450
3"	DN80	15.2	34.2	106.2	382.4	563.8	780
4"	DN100	28.3	65.9	204.6	682.0	1005.0	1360
5"	DN125	32.1	84.6	254.2	885.3	1258.0	1700

F35系列 V型固定球阀 对夹式、法兰式、全口径

F35 series V-shaped fixed ball valve clamp type, flange type, full bore

轶野控制阀门(上海)有限公司
YEAH CONTROL VALVE (SHANGHAI) CO., LTD.



概述及应用

F35系列V型球阀、单阀座设计，流通能力强，具有较大剪切力及自洁功能，特别适用于含纤维或微小固定颗粒状的介质，如纤维、污泥、矿浆等场合；广泛应用于炼油、造纸、化工、石化等行业。

Overview and Application

The F35 series V-type ball valve has a single seat. With powerful flow capacity, it has large shear force and self-cleaning function, especially applicable to fiber-related or tiny fixed granular mediums, such as fiber, sludge, and ore pulp; it is extensively applied to the oil refining, papermaking, chemical engineering, petrochemical, and other industries.

应用场合

- > 造纸工业中的纸浆和纤维控制
- > 生化行业的浆料控制
- > 环保行业的污泥控制
- > 含粉尘和硬质颗粒流体控制
- > 各种流量控制和压力控制

Application Occasions

- Pulp and fiber control for papermaking
- Slurry control for biochemistry
- Sludge control for the environment protection industry
- Fluid control for applications with dust and hard particles
- Various flow controls and pressure controls

技术参数 Technical Parameters

公称通径 Nominal diameter	DN25~DN500(1"~20")
压力等级 Pressure grade	PN16~PN40 Class150~Class300
工作温度 Operating temperature	-40°C~425°C
连接方式 Connection	法兰、对夹 Flange, Wafer
密封形式 Sealing	RPTFE UHMWPE PEEK、全金属阀座
主要材质 Main materials	碳钢、不锈钢、特种合金 Carbon steel, stainless steel, and special alloy

产品认证 Product Certification

- TUV IEC61508-SIL3安全完整性功能认证
- TUV ISO15848低泄漏认证
- TUV API607防火认证
- TUV IEC61508-SIL3 Certification of safety and integrated functions
- TUV ISO15848 Low-leakage certification
- TUV API607 Fireproofing certification



可添加微信
了解更多产品与数据

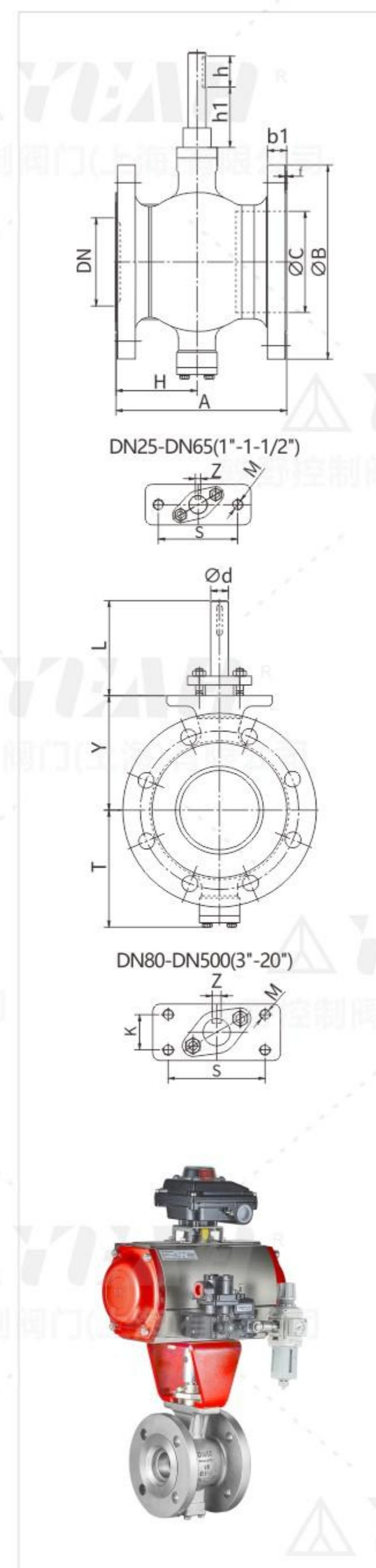

GB DN25-DN500-PN16

DN	A	B	b1	f	C	T	Y	L	Φd	h	S	K	M	Z
25	102	115	16	2	38	81	73	75	16	35	75	/	2-M10	5
32	102	140	18	2	45	86	78	75	16	35	75	/	2-M10	5
40	114	150	18	2	50	90	80	75	16	35	75	/	2-M10	5
50	124	165	20	2	62	93	90	75	16	35	75	/	2-M10	5
65	145	185	20	2	80	108	105	75	16	35	75	/	2-M10	5
80	165	200	20	2	90	123	118	75	20	35	90	28	4-M10	6
100	194	220	22	2	115	138	130	75	20	35	90	28	4-M10	6
125	194	250	22	2	134	148	145	80	25	40	90	28	4-M10	8
150	229	285	24	2	164	170	170	94	30	50	110	40	4-M12	8
200	243	340	24	2	206	200	201	94	30	50	110	40	4-M12	8
250	297	405	26	2	260	240	237	98	40	60	135	40	4-M16	12
300	338	460	28	2	316	286	282	98	40	60	135	40	4-M16	12
350	400	520	30	2	372	330	337	125	50	60	140	64	4-M16	14
400	400	580	32	2	420	367	372	172	60	80	170	80	4-M20	18
450	520	640	40	2	470	422	432	172	70	90	190	90	4-M24	20
500	600	715	44	2	516	490	498	180	80	100	190	90	4-M24	22

GB DN25-DN300-PN25

DN	A	B	b1	f	C	T	Y	L	Φd	h	S	K	M	Z
25	102	115	16	2	40	88	86	75	20	35	90	28	4-M10	6
32	102	140	18	2	48	90	90	75	20	35	90	28	4-M10	6
40	114	150	18	2	56	95	93	80	25	40	90	28	4-M10	8
50	124	165	20	2	65	98	98	80	25	40	90	28	4-M10	8
65	145	185	22	2	80	130	125	95	30	50	110	40	4-M12	8
80	165	200	24	2	95	128	128	95	30	50	110	40	4-M12	8
100	194	235	24	2	115	142	142	95	30	50	110	40	4-M12	8
125	194	270	26	2	138	175	170	100	40	60	135	40	4-M16	12
150	229	300	28	2	170	215	215	125	50	60	140	64	4-M16	14
200	243	360	30	2	208	228	228	125	50	60	140	64	4-M16	14
250	297	425	32	2	265	260	260	150	60	80	170	80	4-M20	18
300	338	485	34	2	320	310	310	150	60	80	170	80	4-M20	18

GB DN25-DN300-PN40

DN	A	B	b1	f	C	T	Y	L	Φd	h	S	K	M	Z
25	102	115	16	2	40	88	86	75	20	35	90	28	4-M10	6
32	102	140	18	2	48	90	90	75	20	35	90	28	4-M10	6
40	114	150	18	2	56	95	93	80	25	40	90	28	4-M10	8
50	124	165	20	2	65	98	98	80	25	40	90	28	4-M10	8
65	145	185	22	2	80	130	125	95	30	50	110	40	4-M12	8
80	165	200	24	2	95	128	128	95	30	50	110	40	4-M12	8
100	194	235	24	2	115	142	142	95	30	50	110	40	4-M12	8
125	194	270	26	2	138	175	170	100	40	60	135	40	4-M16	12
150	229	300	28	2	170	215	215	125	50	60	140	64	4-M16	14
200	243	375	34	2	208	228	228	125	50	60	140	64	4-M16	14
250	297	450	38	2	265	260	260	150	60	80	170	80	4-M20	18
300	338	515	42	2	320	310	310	150	60	80	170	80	4-M20	18

ASME 1"-20"-150LB

SIZE	A	B	b1	f	C	T	Y	L	Φd	h	S	K	M	Z
1"	102	108	14.5	2	38	81	73	75	16	35	75	/	2-M10	5
1 1/4"	102	115	14.5	2	45	86	78	75	16	35	75	/	2-M10	5
1 1/2"	114	127	14.5	2	50	90	80	75	16	35	75	/	2-M10	5
2"	124	152	16.3	2	62	93	90	75	16	35	75	/	2-M10	5
2 1/2"	145	180	18	2	80	108	105	75	16	35	75	/	2-M10	5
3"	165	191	19.5	2	90	123	118	75	20	35	90	28	4-M10	6
4"	194	230	24	2	115	138	130	75	20	35	90	28	4-M10	6
5"	194	255	24.3	2	134	148	145	80	25	40	90	28	4-M10	8
6"	229	280	26	2	164	170	170	94	30	50	110	40	4-M12	8
8"	243	340	29	2	206	200	201	94	30	50	110	40	4-M12	8
10"	297	405	30.6	2	260	240	237	98	40	60	135	40	4-M16	12
12"	338	485	32.2	2	316	286	282	98	40	60	135	40	4-M16	12
14"	400	535	35.4	2	372	330	337	125	50	60	140	64	4-M16	14
16"	400	595	37	2	420	367	372	172	60	80	170	80	4-M20	18
18"	520	635	40.1	2	470	422	432	170	70	90	190	90	4-M24	20
20"	600	700	44	2	516	490	498	180	80	100	190	90	4-M24	22

ASME 1"-12"-300LB

SIZE	A	B	b1	f	C	T	Y	L	Φd	h	S	K	M	Z
1"	102	125	18	2	40	88	86	75	20	35	90	28	4-M10	6
1 1/4"	102	135	19.5	2	48	90	90	75	20	35	90	28	4-M10	6
1 1/2"	114	155	21	2	56	95	93	80	25	40	90	28	4-M10	8
2"	124	165	23	2	65	98	98	80	25	40	90	28	4-M10	8
2 1/2"	145	190	26	2	80	130	125	95	30	50	110	40	4-M12	8
3"	165	210	29	2	95	128	128	95	30	50	110	40	4-M12	8
4"	194	255	32.2	2	115	142	142	95	30	50	110	40	4-M12	8
5"	194	280	35.6	2	138	170	170	100	40	60	135	40	4-M16	12
6"	229	320	37	2	170	215	215	125	50	60	140	64	4-M16	14
8"	243	380	42	2	208	228	228	125	50	60	140	64	4-M16	14
10"	297	445	48.1	2	265	260	260	150	60	80	170	80	4-M20	18
12"	338	520	49.3	2	320	310	310	150	60	80	170	80	4-M20	18

备注：对夹式数据请联系厂家。

F50系列 三段式高温高压球阀 法兰式、全口径

F50 series three stage high-temperature and high-pressure ball valve flange type, full bore

轶野控制阀门(上海)有限公司
YEAH CONTROL VALVE (SHANGHAI) CO., LTD.



轶野控制阀门(上海)有限公司

可选驱动配置 Optional driver configuration



概述及应用

F50系列硬密封球阀阀座表面硬化处理, 球体喷涂/喷焊硬质合金, 密封阀座使用弹簧加载, 刮刀结构, 在较大的温度和压力变化范围内具有优良的密封性能, 确保在高温、高压工况下依然运行稳定。该系列阀门主要适用于工况比较恶劣的情况下, 它可满足高温、高压、耐磨、强腐蚀以及含有颗粒性介质等恶劣工况。

产品特点

- > 执行机构连接采用ISO5211国际标准
- > 全口径结构及锁定装置设计
- > 流通能力强、流阻小、双向密封
- > 阀杆防飞出结构、防火、防静电设计
- > 阀腔带自泄压
- > 阀座带有自洁功能
- > 可选多种执行机构

技术参数 Technical Parameters

公称通径 Nominal diameter	DN150~DN1400(2"~32")
压力等级 Pressure grade	PN16~PN64 Class150~Class600
工作温度 Operating temperature	-40°C~425°C
连接方式 Connection	法兰 Flange
密封形式 Sealing	RPTFE UHMWPE PEEK、全金属阀座
主要材质 Main materials	碳钢、不锈钢、特种合金 Carbon steel, stainless steel, and special alloy

Overview and Application

Surface hardening is performed for the F50 Series metal-seated ball seat; hard alloy painting/spray welding is performed for the ball; a spring is used for the sealed seat for loading, and a scraper structure is used as well; it has excellent sealing properties in considerable ranges of temperature and pressure variations to ensure stable operations in high temperature, high pressure, and other working conditions. The series is mainly applied to severe working conditions, and it can meet adverse working conditions, such as high temperature, high pressure, wear, strong corrosion, and those with granular mediums.

Product Features

- The international standard ISO5211 is adopted for the actuator;
- Full-bore structure and lock device design;
- Excellent flow capacity, small flow resistance, and two-way sealing;
- Stem anti-popping structure, fireproof and anti-static design;
- Cavity with self-pressure relief;
- Seat with self-cleaning function;
- Multiple actuators are optional.

产品认证 Product Certification

- TUV IEC61508-SIL3安全完整性功能认证
- TUV ISO15848低泄漏认证
- TUV API607防火认证
- TUV IEC61508-SIL3 Certification of safety and integrated functions
- TUV ISO15848 Low-leakage certification
- TUV API607 Fireproofing certification

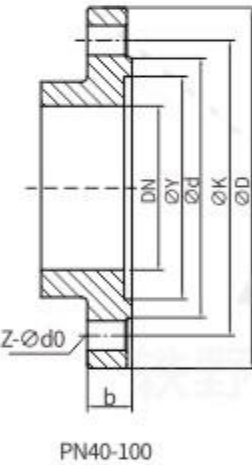
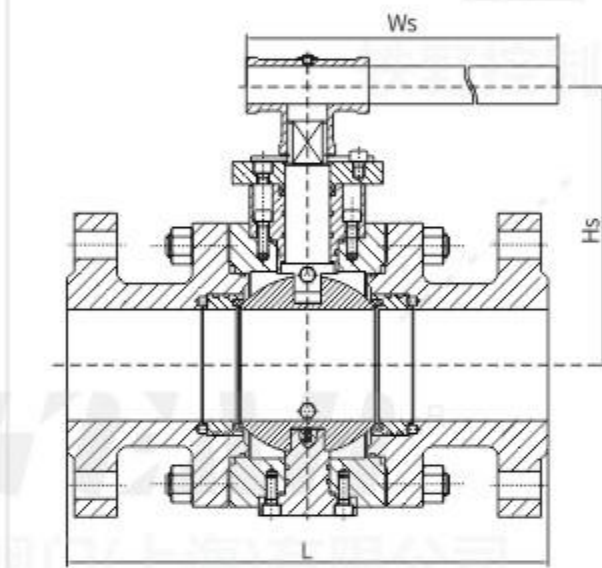
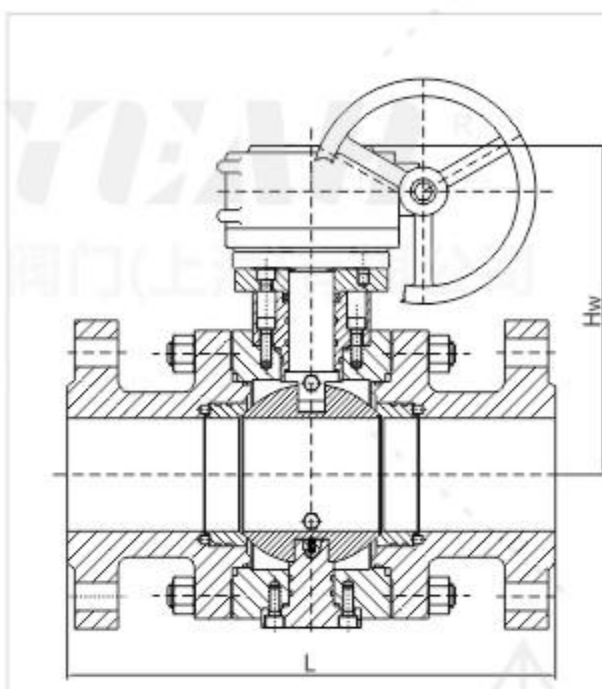

GB DN150-DN1400-PN16

DN	L	D	K	d	Y	b	Z-Ø	Ws	Hw
150	394	280	240	210	-	24	8-23	1000	470
200	457	330	245	265	-	24	12-25	-	520
250	533	405	355	320	-	28	12-25	-	610
300	610	460	410	375	-	28	16-25	-	650
350	686	520	470	435	-	36	16-25	-	740
400	762	580	525	485	-	36	16-30	-	795
450	864	640	585	545	-	38	20-30	-	860
500	914	705	650	608	-	42	20-34	-	945
600	1067	840	770	718	-	46	20-41	-	1040
700	1245	910	840	788	-	48	24-41	-	1150
800	1372	1020	950	898	-	50	24-41	-	1280
900	1524	1120	1050	998	-	52	28-41	-	1430
1000	1753	1255	1170	1110	-	54	28-48	-	1580
1200	2032	1485	1390	1320	-	56	32-54	-	1810
1400	2300	1685	1590	1525	-	60	36-54	-	2010

GB DN150-DN1400-PN25

DN	L	D	K	d	Y	b	Z-Ø	Ws	Hw
150	403	300	250	218	-	30	8-25	1000	470
200	501	360	310	278	-	36	12-30	-	540
250	568	425	370	338	-	36	12-30	-	630
300	648	485	430	390	-	40	16-30	-	650
350	762	550	490	448	-	44	16-34	-	740
400	838	610	550	505	-	48	16-34	-	795
450	914	660	600	555	-	50	20-34	-	860
500	991	730	660	610	-	52	20-41	-	945
600	1143	840	770	718	-	56	20-41	-	1040
700	1346	955	875	815	-	60	24-48	-	1150
800	1524	1070	990	930	-	64	24-48	-	1305
900	1727	1180	1090	1025	-	66	28-54	-	1505
1000	1880	1305	1210	1140	-	68	28-58	-	1625
1200	2184	1525	1420	1350	-	72	32-58	-	1925
1400	2300	1750	1640	1560	-	78	36-65	-	2110

GB DN150-DN1400-PN40

DN	L	D	K	d	Y	b	Z-Ø	Ws	Hw
150	403	300	250	218	204	30	8-25	1200	485
200	501	360	310	278	260	36	12-30	-	580
250	568	425	370	338	313	36	12-30	-	660
300	648	485	430	408	364	46	16-34	-	760
350	762	550	490	465	422	46	16-34	-	820
400	838	610	550	535	474	58	16-41	-	860
450	914	660	610	560	524	60	20-41	-	930
500	991	730	660	612	576	62	20-48	-	980
600	1143	840	795	730	678	62	20-54	-	1040
700	1346	955	900	835	768	68	24-54	-	1150
800	1524	1135	1030	960	876	76	24-58	-	1305
900	1727	1270	1168	1022	-	105	32-54	-	1505
1000	1880	1238	1156	1086	-	114	32-54	-	1615
1200	2184	1467	1307	1308	-	133	36-51	-	1925
1400	2300	1708	1600	1518	-	154	38-60	-	2110

GB DN15-DN1200-PN64

DN	L	D	K	d	Y	b	Z-Ø	Ws	Hw
150	495	340	280	240	204	38	8-34	1200	485
200	597	405	345	300	260	44	12-34	-	580
250	673	470	400	352	313	48	12-34	-	660
300	762	530	460	415	364	54	16-41	-	760
350	826	595	525	475	422	56	16-41	-	820
400	902	670	585	525	474	66	16-48	-	870
500	1054	800	705	640	576	70	20-54	-	995
600	1232	930	820	750	678	76	20-58	-	1100
700	1397	1035	940	800	-	95	28-51	-	1180
800	1651	1149	1054	914	-	108	28-54	-	1345
900	1880	1270	1168	1022	-	114	32-54	-	1550
1000	1981	1270	1175	1092	-	133	32-51	-	1675
1200	2311	1511	1403	1308	-	152	38-60	-	1945

ASME 2"-32"-150LB

SIZE	L	D	K	d	Y	b	Z-Ø	Ws	Hw
2 1/2"	178	152	120.7	92	-	14.3	4-19	260	-
3"	190	178	139.7	105	-	15.9	4-19	350	-
4"	203	190	152.4	127	-	17.5	4-19	500	-
5"	229	216	171.5	152	-	21.3	8-19	650	390
6"	244	254	190.5	186	-	23.9	8-25.5	800	410
8"	344	279	241.3	216	-	29.0	8-25.5	1000	470
10"	457	343	298.5	270	-	37.0	8-25.5	-	520
12"	533	406	362	324	-	46.0	12-25.5	-	610
14"	610	483	431.8	381	-	55.0	12-25.5	-	650
16"	696	533	476.3	413	-	63.0	12-28.5	-	740
18"	762	597	539.8	470	-	71.0	16-28.5	-	795
20"	864	635	577.9	533	-	81.0	16-32	-	860
24"	914	699	635.0	584	-	91.0	20-32	-	945
28"	1067	813	749.3	692	-	105.0	20-35	-	1040
32"	1245	927	864	800	-	121.0	28-35	-	1150
	1372	1060	978	914	-	137.0	28-41	-	1280

ASME 2"-20"-300LB

SIZE	L	D	K	d	Y	b	Z-Ø	Ws	Hw
2 1/2"	216	165	127	92	-	20.7	8-19	260	-
3"	241	190	149.2	105	-	23.9	8-22.5	350	-
4"	282	210	168.3	127	-	27.0	8-22.5	500	-
5"	305	254	200	157	-	30.2	8-22.5	800	410
6"	381	279	235	186	-	35.0	8-22.5	1000	470
8"	493	318	279.9	216	-	42.0	12-22.5	1200	485
10"	502	381	330.2	270	-	39.7	12-25.5	-	580
12"	568	445	387.4	324	-	46.1	16-28.5	-	665
14"	648	521	450.8	381	-	49.3	16-32	-	760
16"	762	584	514.4	413	-	52.4	20-32	-	820
18"	838	648	571.5	470	-	55.6	20-35	-	860
20"	914	711	628.5	533	-	58.8	24-35	-	930
24"	991	813	749.3	600	-	62.0	24-35	-	980

ASME 2"-12"-600LB

SIZE	L	D	K	d	Y	b	Z-Ø	Ws	Hw
2"	292	165	127	92	-	25.4	8-19	350	-
2 1/2"	330	190	149.2	105	-	28.6	8-22.5	500	-
3"	356	210	168.3	127	-	31.8	8-22.5	650	-
4"	432	273	215.9	175	-	38.1	8-25.5	1000	395
5"	508	330	267.7	210	-	44.5	8-28.5	1200	430
6"	559	356	292.1	241	-	47.7	12-28.5	-	495
8"	660	419	349.2	302	-	55.6	12-32	-	595
10"	787	478	413.8	356	-	63.2	16-32	-	680
12"	838	559	489.0	413	-	66.7	20-35	-	790

F60系列 倾斜式放料球阀 法兰式、全口径

F60 series inclined discharge ball valve flange type, full bore

轶野控制阀门(上海)有限公司
YEAH CONTROL VALVE (SHANGHAI) CO., LTD.

可选驱动配置 Optional driver configuration

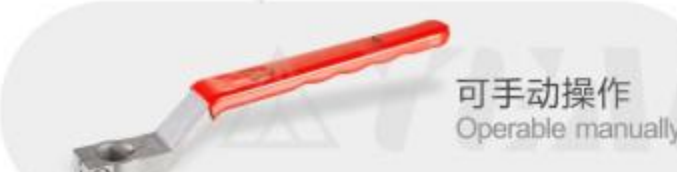

概述及应用

F60系列放料球阀，阀座与端面法兰距离近，物料滞留少，结构紧凑，密封性能优越，用于精细化工、制药、化工行业反应锅上，也可用于细软颗粒介质输送。采用PPL密封材料，更具耐磨。

Overview and Application

The F60 series discharge ball valve has a close distance between the valve seat and the end face flange, with less material retention, compact structure, and superior sealing performance. It is used in reaction pots in the fine chemical, pharmaceutical, and chemical industries, and can also be used for conveying fine and soft particle media. Using PPL sealing material, it is more wear-resistant.

产品特点

- > 执行机构连接采用ISO5211国际标准
- > 全口径结构及锁定装置设计
- > 流通能力强、流阻小、双向密封
- > 阀杆防飞出结构、防火、防静电设计
- > 阀腔带自泄压
- > 阀座带有自洁功能
- > 可选多种执行机构

Product Features

- The international standard ISO5211 is adopted for the actuator;
- Full-bore structure and lock device design;
- Excellent flow capacity, small flow resistance, and two-way sealing;
- Stem anti-popping structure, fireproof and anti-static design;
- Cavity with self-pressure relief;
- Seat with self-cleaning function;
- Multiple actuators are optional.

技术参数 Technical Parameters

公称通径 Nominal diameter	DN15~DN150(1/2"~4")
压力等级 Pressure grade	PN16 Class150
工作温度 Operating temperature	-40°C~425°C
连接方式 Connection	法兰 Flange
密封形式 Sealing	RPTFE UHMWPE PEEK、全金属阀座
主要材质 Main materials	碳钢、不锈钢、特种合金 Carbon steel, stainless steel, and special alloy

产品认证 Product Certification

- TUV IEC61508-SIL3安全完整性功能认证
- TUV ISO15848低泄漏认证
- TUV API607防火认证
- TUV IEC61508-SIL3 Certification of safety and integrated functions
- TUV ISO15848 Low-leakage certification
- TUV API607 Fireproofing certification



可添加微信
了解更多产品与数据

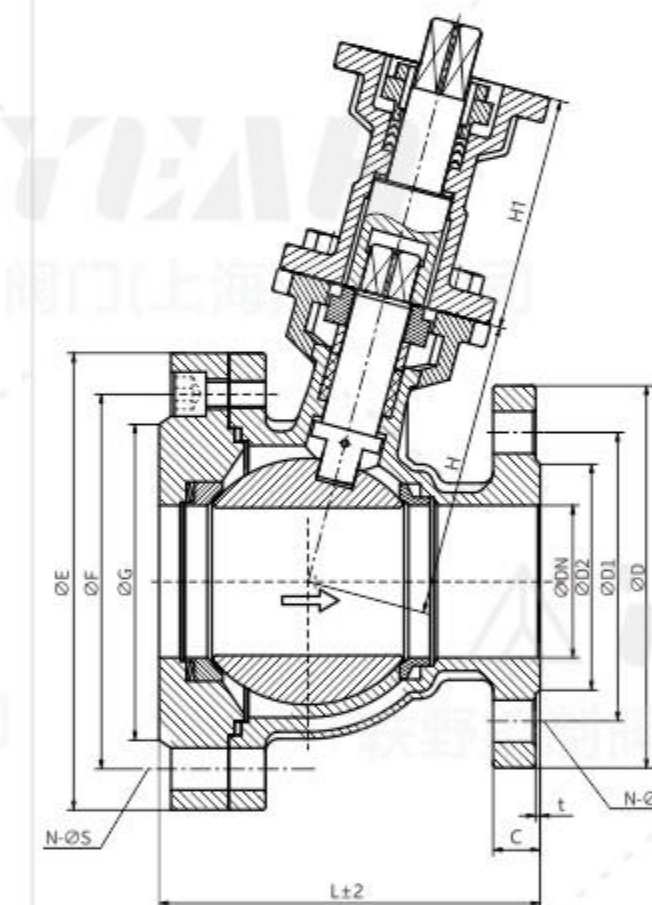
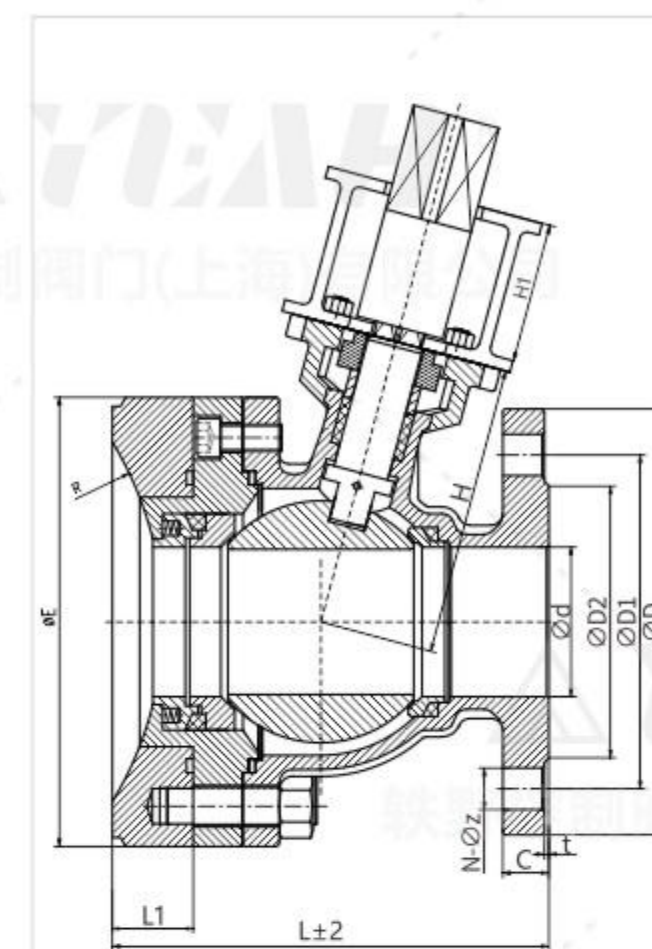

GB DN50-DN150-PN16 (焊接Welding)

DN	L	D	D1	D2	C	t	N-Φz	A	B	H	E	R	L1	K*K	H1
50	160	165	125	100	20	2	4-Φ18	70	50	112	180	170	35	14	80
65	190	185	145	118	20	3	8-Φ18	102	70	125	195	180	35	17	100
80	203	200	160	135	20	2	8-Φ18	102	70	132	218	260	45	17	100
100	243	220	180	155	22	2	8-Φ18	125	102	160	250	263	45	22	93
125	275	250	210	188	22	3	8-Φ18	140	102	190	340	290	50	22	93
150	315	285	240	212	24	3	8-Φ22	140	102	210	340	450	55	27	93

GB DN40-DN100-PN16 (法兰Flange)

DN	L	D	D1	D2	C	t	N-Φz	A	B	H	E	F	G	N-Φs	K*K	H1
40	120	150	110	85	18	2	4-Φ18	70	50	105	165	125	100	4-Φ18	14	80
50	135	165	125	100	20	2	4-Φ18	70	50	112	185	145	118	4-Φ18	14	80
65	160	185	145	118	20	3	8-Φ18	102	70	125	200	160	135	8-Φ18	17	100
80	170	200	160	135	20	2	8-Φ18	102	70	132	220	180	155	8-Φ18	17	100
100	200	220	180	155	22	2	8-Φ18	125	102	160	250	210	188	8-Φ18	22	93

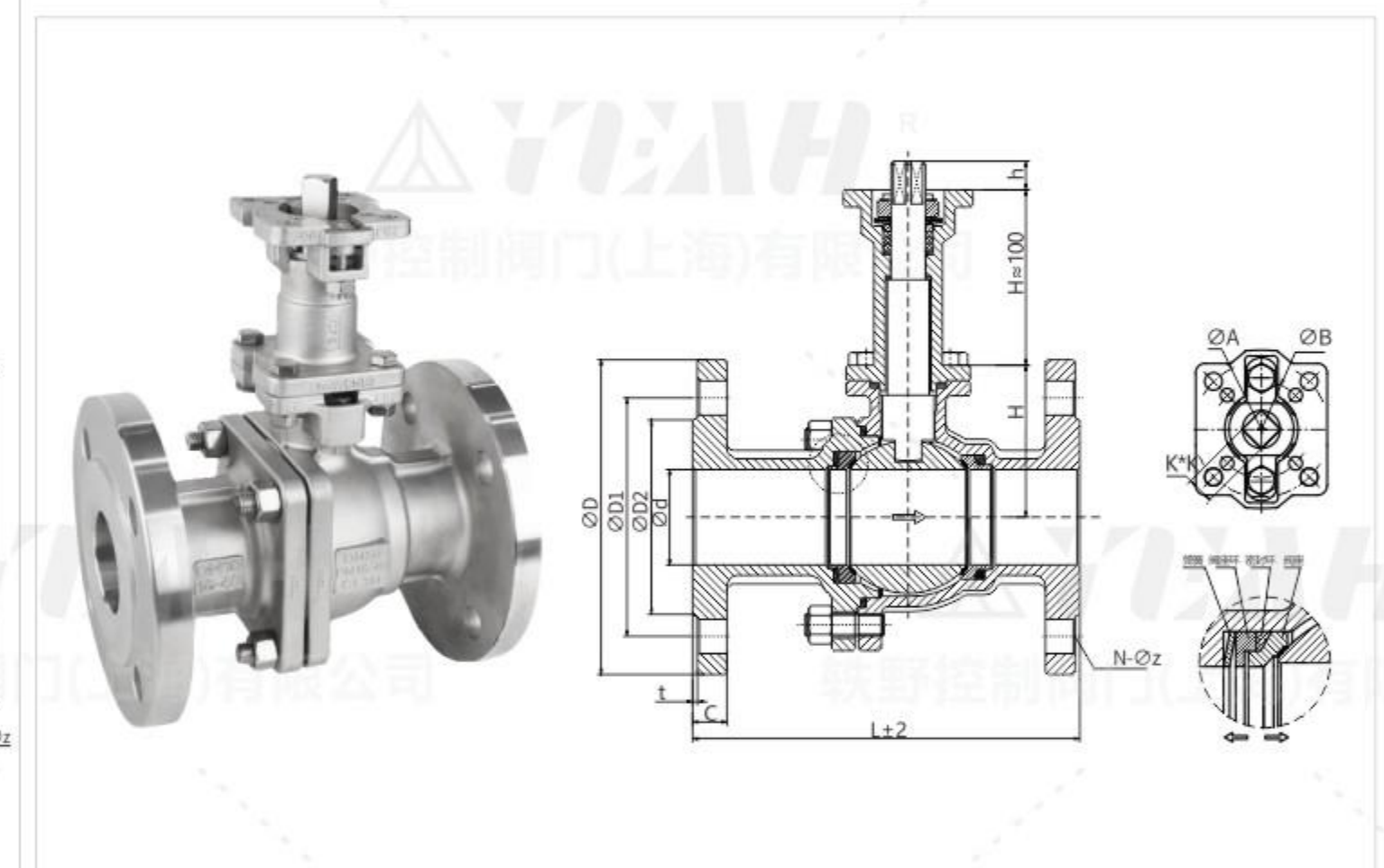

GB/ASME

SIZE	d	D	D1	D2	C	t	L	H	N-Φz	A	B	K*K	h
1/2"	DN15	95	65	45	16	2	130	40	4-Φ14	50	36	9	9
3/4"	DN20	105	75	75	18	2	130	44	4-Φ14	50	36	9	9
1"	DN25	115	85	85	18	2	140	51	4-Φ14	50	42	11	11
1 1/4"	DN32	140	100	100	18	2	165	58	4-Φ18	50	42	11	11
1 1/2"	DN40	150	110	110	18	3	165	63	4-Φ18	70	50	14	14.5
2"	DN50	165	125	125	18	3	203	72	4-Φ18	70	50	14	14.5
2 1/2"	DN65	185	145	145	18	3	222	94	8-Φ18	102	70	17	18.5
3"	DN80	200	160	160	20	3	241	107	8-Φ18	102	70	17	18.5
4"	DN100	220	180	180	20	3	305	130	8-Φ18	102	/	22	22

F45系列 双向流硬碰硬旋球阀 法兰式

F45 series bidirectional flow hard contact hard rotary ball valve flange type

轶野控制阀门(上海)有限公司
YEAH CONTROL VALVE (SHANGHAI) CO., LTD.

可选驱动配置 Optional driver configuration



可手动操作
Operable manually



可蜗轮操作
Operable worm gear



可气动操作
Operable pneumatic



可电动操作
Operable electrically

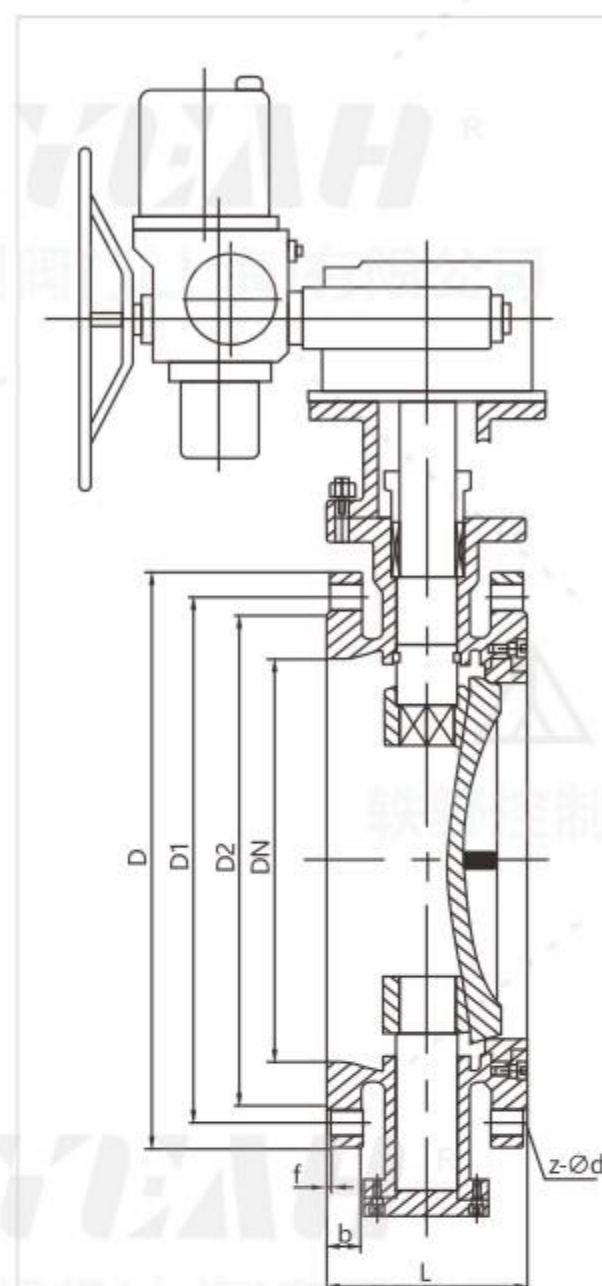

概述及应用

F45系列旋转控制阀, 是在偏心阀的基础上, 综合了球阀、半球阀、多偏心蝶阀和单座阀的优点, 能达到VI级泄漏等级, 尤其适用于大流量、高粘度 and 含有颗粒状结垢结晶等介质的场合。

Overview and Application

Based on the eccentric valves, the F45 series rotary control valve combines the strengths of ball valves, semi-ball valves, multi-eccentric butterfly valves and single seated valves. Being able to reach the VI leakage level, it is especially applicable to scenarios of large flows, high viscosity and those with granular scaling, crystal, and other mediums.

产品特点

- > 耐泥沙磨损
- > 阀门启闭灵活, 不受介质压力高低的影响
- > 阀座与阀板无启闭摩擦, 具有越关越紧的密封性
- > 阀板密封圈具有密封补偿功能

Product Features

- Resistant to mud and sand abrasion
- The valve opens and closes flexibly, unaffected by the pressure of the medium
- The valve seat and valve plate have no opening and closing friction, and have a tighter sealing performance as they close
- The valve plate sealing ring has a sealing compensation function

技术参数 Technical Parameters

公称通径 Nominal diameter	DN50~DN1200
压力等级 Pressure grade	PN10~PN25
工作温度 Operating temperature	-40°C~500°C
连接方式 Connection	法兰 Flange
密封形式 Sealing	RPTFE UHMWPE PEEK、全金属阀座
主要材质 Main materials	碳钢、不锈钢、特种合金 Carbon steel, stainless steel, and special alloy

产品认证 Product Certification

TUV IEC61508-SIL3安全完整性功能认证
TUV ISO15848低泄漏认证
TUV API607防火认证

TUV IEC61508-SIL3 Certification of safety and integrated functions
TUV ISO15848 Low-leakage certification
TUV API607 Fireproofing certification



可添加微信
了解更多产品与数据

GB DN50-DN1200-PN10

DN	L		D	D1	D2	b	f	Z-Ød
	短	长						
50	108	150	160	125	100	16	3	4-18
65	112	170	180	145	120	18	3	4-18
80	114	180	195	160	135	18	3	4-18
100	127	190	215	180	155	20	3	8-18
125	140	200	245	210	185	22	3	8-18
150	140	210	280	240	210	22	3	8-23
200	152	230	335	295	265	22	3	8-23
250	165	250	390	350	320	24	3	12-23
300	178	270	440	400	368	26	4	12-23
350	190	290	500	460	428	26	4	16-23
400	216	310	565	515	482	26	4	16-25
450	222	330	615	565	582	26	4	20-25
500	229	350	670	620	585	28	4	20-25
600	267	390	780	725	685	28	5	20-30
700	292	430	895	840	800	30	5	24-30
800	318	470	1010	950	905	32	5	24-34
900	330	510	1110	1050	1005	34	5	28-34
1000	410	550	1220	1160	1115	34	5	28-34
1200	470	630	1450	1380	1325	38	5	32-41

GB DN50-DN1200-PN16

DN	L		D	D1	D2	b	f	Z-Ød
	短	长						
50	108	150	160	125	100	16	3	4-18
65	112	170	180	145	120	18	3	4-18
80	114	180	195	160	135	20	3	8-18
100	127	190	215	180	155	20	3	8-18
125	140	200	245	210	185	22	3	8-18
150	140	210	280	240	210	24	3	8-18
200	152	230	335	295	265	26	3	8-23
250	165	250	405	335	320	30	3	12-23
300	178	270	460	410	375	30	4	12-25
350	190	290	520	470	435	34	4	12-25
400	216	310	580	525	485	36	4	16-30
450	222	330	640	585	545	40	4	20-30
500	229	350	705	650	608	44	4	20-34
600	267	390	840	770	718	48	5	20-41
700	292	430	910	840	788	50	5	24-41
800	318	470	1020	950	898	52	5	24-41
900	330	510	1120	1050	998	54	5	28-41
1000	410	550	1255	1170	1110	56	5	28-48
1200	470	630	1485	1390	1288	58	5	32-54

GB DN50-DN1200-PN25

DN	L		D	D1	D2	b	f	Z-Ød
	短	长						
50	108	150	160	125	100	20	3	4-18
65	112	170	180	145	120	22	3	8-18
80	114	180	195	160	135	22	3	8-18
100	127	190	230	190	160	24	3	8-23
125	140	200	270	220	188	28	3	8-25
150	140	210	300	250	218	30	3	8-25
200	152	230	360	310	278	34	3	12-25
250	165	250	425	370	332	36	3	12-30
300	178	270	485	430	390	40	4	16-30
350	190	290	550	490	448	44	4	16-34
400	216	310	610	550	505	48	4	16-34
450	222	330	660	600	555	50	4	20-34
500	229	350	730	660	610	52	4	20-41
600	267	390	840	770	718	56	5	20-41
700	292	430	955	875	518	60	5	24-48
800	318	470	1070	990	930	64	5	24-48
900	330	510	1180	1090	1025	66	5	28-54
1000	410	550	1305	1210	1140	68	5	28-58
1200	470	630	1525	1420	1350	72	5	32-58



F40系列 衬四氟球阀 法兰式、全通径

F40 series PTFE lined ball valve flange type, full bore

轶野控制阀门(上海)有限公司
YEAH CONTROL VALVE (SHANGHAI) CO., LTD.

Unit:mm

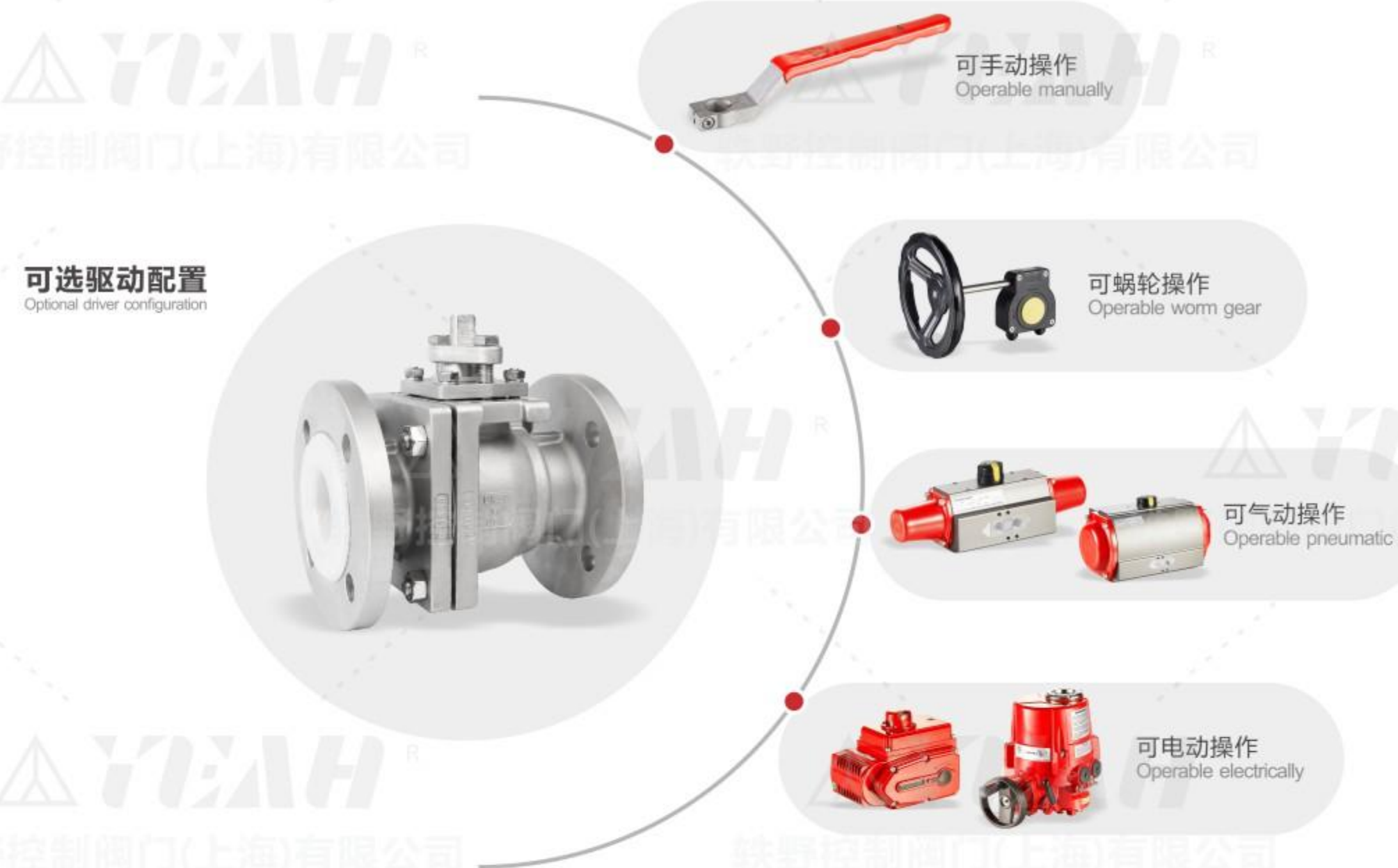

可选驱动配置
Optional driver configuration

可手动操作
Operable manually

可蜗轮操作
Operable worm gear

可气动操作
Operable pneumatic

可电动操作
Operable electrically

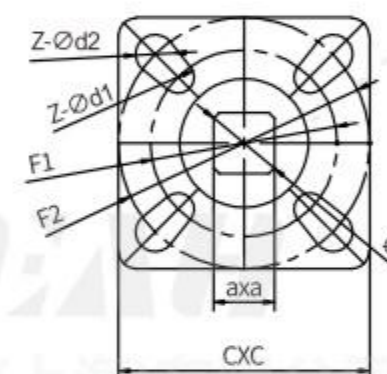
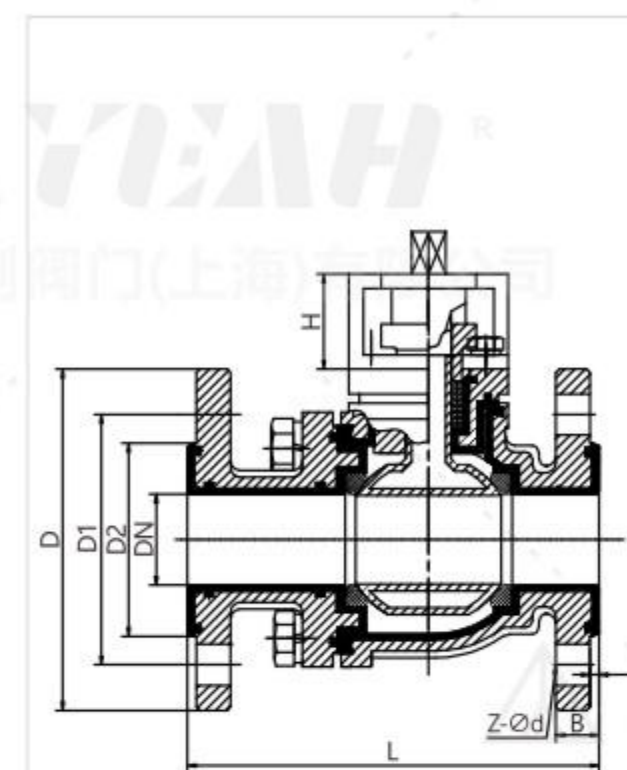

GB

DN	L	D	D1	D2	f	B	Z-Φd	H	F1	Z-Φd1	F2	Z-Φd2	axa	ΦA	CxC
15	140	95	65	45	3	16	4-14	58	50	4-9	-	-	14	18	50
20	140	105	75	55	3	18	4-14	58	50	4-9	-	-	14	18	50
25	150	115	85	65	3	18	4-14	62	50	4-9	70	4-10	14	18	65
32	165	140	100	75	3	18	4-18	62	50	4-9	70	4-10	14	18	65
40	180	150	110	85	3	18	4-18	63	50	4-9	70	4-10	17	22	70
50	200	165	125	100	3	18	4-18	63	50	4-9	70	4-10	17	22	70
65	220	185	145	120	3	18	8-18	70	102	4-12	125	4-14	17	22	118
80	250	200	160	135	3	20	8-18	76	102	4-12	125	4-14	22	29	118
100	280	220	180	155	3	20	8-18	76	102	4-12	125	4-14	22	29	118
125	320	250	210	185	4	22	8-18	90	125	4-14	140	4-18	36	49	130
150	360	285	240	210	4	22	8-22	90	125	4-14	140	4-18	36	49	130
200	457	340	295	265	4	24	8-22	140	140	4-18	165	4-22	36	49	165

氟塑料衬里性能表 Performance Table of Fluoroplastic Lining

	介质	浓度(%)	温度	PTFE	PCTFE	PVDF	FEP	PEA
耐腐蚀性能	硫酸	10~98	常温~100	A	A~B	A~B	A	A
	硝酸	5~98	常温~100	A	A	A	A	A
	盐酸	10~38	常温~100	A	A	A	A	A
	醋酸	10~100	常温~100	A	A~B	A~B	A	A
	铬酸	50~100	常温~70	A	A~B	A~B	A	A
	磷酸	50~85	常温~100	A~B	A	A	A~B	A~B
	三氯甲烷	100	常温	C	D	D	C	C
	硫酸铜	15	常温	A	B	B	A	A
	二乙醚	100	常温	B	C	C	A	B
	醋酸乙醚	100	常温	B	C	C	C	B
	汽油	100	常温	A	A	A	A	A
	过氧化氢	3~30	常温	A	A~B	A~B	A	A
	王水	-	常温	A	A	A	A	A
	硝基苯	100	常温	A	B	B	A	A
	苛性钠	10~50	常温~100	A	A~B	A~B	A	A
	次氯酸钠	-	70	A	A	A	A	A
氯氨酸	40~99	-10~30	A~B	B	B	A~B	A~B	
发烟硫酸	20	常温	A	B	B	A	A	
丙烯腈	-	常温	B	C	C	B	B	
苯胺	100	常温	B	B	B	B	B	
苯	100	常温	B	C	C	C	B	
醋酸丁酯	100	常温	B	C	C	B	B	
四氯化碳	试剂级	常温	B	C	C	B	B	

A,B,C,D 表示耐腐蚀性能, 分别为优、良、可、差四个级别。
A, B, C, D represent corrosion resistance performance, which are classified into four levels: excellent, good, acceptable, and poor.

概述及应用

衬四氟球阀可分为对分二片式和三片式两种结构型式, 除具有的流体阻力小, 启闭速度快, 结构简单外, 采用FEP衬里层的球阀, 具有极高的化学稳定性, 可以适用除“熔融碱金属和元素氟”, 以外其它任何强腐蚀性物质。

采用全通径、浮动球结构, 阀门可在整个压力范围内进行无泄漏关闭, 更便于管路系统的通球扫线和管路维护。

启闭件球体与阀杆铸(锻)为一体, 杜绝了由于压力变化引起阀杆冲出承压件内的可能性, 从根本上保证了工程中的使用安全性。

结构紧凑合理, 阀体内腔空间最小, 减小了介质滞留, 另外, 特殊的模压工艺, 使密封面致密度良好, 加之人字环形PTFE填料组合, 使阀门达到零泄漏。

Overview and Application

PTFE lined ball valves can be divided into two-piece and three piece structural types. In addition to having low fluid resistance, fast opening and closing speed, and simple structure, ball valves with FEP lining layer have extremely high chemical stability and can be applied to any strong corrosive properties except for "molten alkali metals and elemental fluorine". Adopting a full bore and floating ball structure, the valve can be closed without leakage throughout the entire pressure range, making it easier for the pipeline system to pass through the ball and maintain the pipeline. The opening and closing ball parts are integrated with the valve stem cast (forged), eliminating the possibility of the valve stem being ejected from the pressure bearing parts due to pressure changes, fundamentally ensuring the safety of use in engineering. The structure is compact and reasonable, with the smallest internal space of the valve body, reducing medium retention. In addition, the special molding process ensures good density of the sealing surface, and the combination of herringbone ring PTFE packing enables the valve to achieve zero leakage.

技术参数 Technical Parameters

公称通径 Nominal diameter	DN15~DN200
压力等级 Pressure grade	PN16
工作温度 Operating temperature	-190°C ~ 250°C
连接方式 Connection	法兰 Flange
密封形式 Sealing	PTFE PCTFE FEP PO
主要材质 Main materials	碳钢、不锈钢 Carbon steel, stainless steel

产品认证 Product Certification

TUV IEC61508-SIL3安全完整性功能认证
TUV ISO15848低泄漏认证
TUV API607防火认证

TUV IEC61508-SIL3 Certification of safety and integrated functions
TUV ISO15848 Low-leakage certification
TUV API607 Fireproofing certification



可添加微信
了解更多产品与数据



F55系列 三段式对焊/螺纹球阀

F55 series three stage butt welded/threaded ball valve

轶野控制阀门(上海)有限公司
YEAH CONTROL VALVE (SHANGHAI) CO., LTD.

可选驱动配置

Optional driver configuration



可手动操作
Operable manually



可蜗轮操作
Operable worm gear



可气动操作
Operable pneumatic



可电动操作
Operable electrically

概述及应用

F55系列高平台采用ISO5211设计, 驱动装置安装便捷, 此款球阀结构简单, 体积小, 重量轻, 便于安装及快速维护, 多种的连接方式, 使用范围更加的广泛。如:法兰连接、卡箍连接、螺纹连接、对焊连接、承插焊连接等特点, 适应不同连接要求。该产品还可提供线性流道口、V型流道口等。

产品特点

- > 执行机构连接采用ISO5211国际标准
- > 全通径结构及锁定装置设计
- > 流通能力强、流阻小、双向密封
- > 阀杆防飞出结构、防火、防静电设计
- > 阀腔带自泄压
- > 阀座带有自洁功能
- > 可选多种执行机构

技术参数 Technical Parameters

公称通径 Nominal diameter	DN15~DN100(1/2"~4")
压力等级 Pressure grade	PN16 Class150
工作温度 Operating temperature	-40°C~425°C
连接方式 Connection	卡箍、螺纹、对焊、承插焊 Clamps, threads, butt welding, socket welding
密封形式 Sealing	RPTFE UHMWPE PEEK、全金属阀座
主要材质 Main materials	碳钢、不锈钢、特种合金 Carbon steel, stainless steel, and special alloy

Overview and Application

The F55 series high platform adopts ISO5211 design, and the drive device is easy to install. This ball valve has a simple structure, small size, light weight, easy installation and quick maintenance, and multiple connection methods, making it more widely used. Features such as flange connection, clamp connection, threaded connection, butt welding connection, socket welding connection, etc., adapt to different connection requirements. This product can also provide linear channel ports, V-shaped channel ports, etc.

Product Features

- The international standard ISO5211 is adopted for the actuator;
- Full-bore structure and lock device design;
- Excellent flow capacity, small flow resistance, and two-way sealing;
- Stem anti-popping structure, fireproof and anti-static design;
- Cavity with self-pressure relief;
- Seat with self-cleaning function;
- Multiple actuators are optional.

产品认证 Product Certification

TUV IEC61508-SIL3安全完整性功能认证
TUV ISO15848低泄漏认证
TUV API607防火认证

TUV IEC61508-SIL3 Certification of safety and integrated functions
TUV ISO15848 Low-leakage certification
TUV API607 Fireproofing certification



可添加微信
了解更多产品与数据

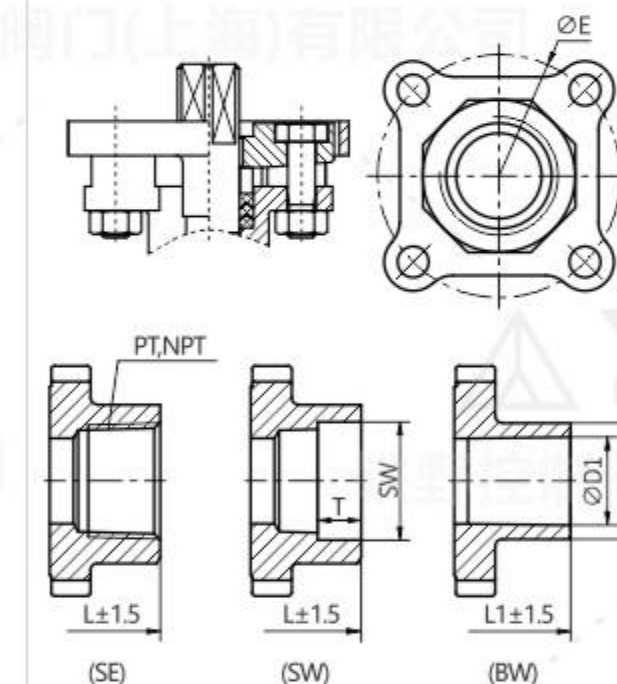
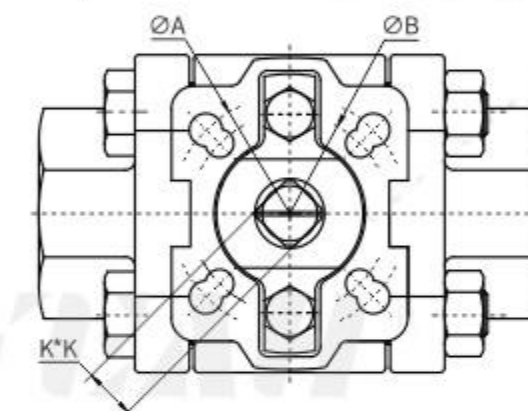
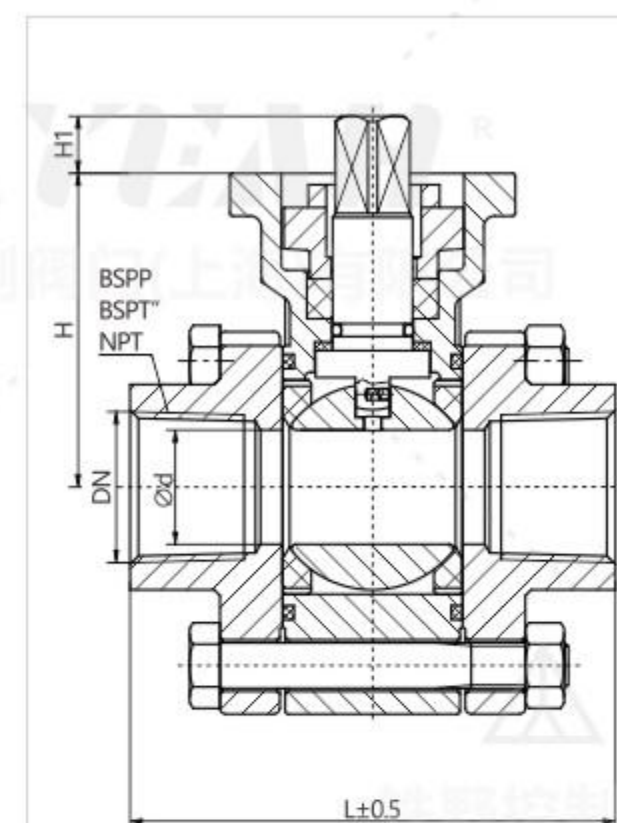

Q11F-1000WOG

SIZE	WOG		d	L	H	H1	K*K	NPS	A	B
1/2"	1000	NPT	15	73	45	9	9	28	50	36
3/4"	1000		20	80	46	9	9	34	50	36
1"	1000		25	90	56	11	11	42	50	42
1 1/4"	1000	BSPT	32	110	70	11	11	52	50	42
1 1/2"	1000		38	120	79	14	14	58.5	70	50
2"	1000		50	140	87	14	14	71.5	70	50
2 1/2"	1000	DIN	64	184	114	17	17	87	102	70
3"	1000		72	205	121	17	17	101	102	70
4"	1000		100	240	140	17	17	128	102	70

Q11F-2000WOG

SIZE	WOG		d	L	H	H1	K*K	NPS	A	B
1/2"	2000	NPT	15	75	56	11	11	-	50	42
3/4"	2000		20	80	59	11	11	-	50	42
1"	2000		25	92	61	11	11	-	50	42
1 1/4"	2000	BSPT	32	110	75	14	14	-	70	50
1 1/2"	2000		38	124	78	14	14	-	70	50
2"	2000		50	150	104	17	17	-	102	70
2 1/2"	2000	DIN	64	185	112	17	17	-	102	70

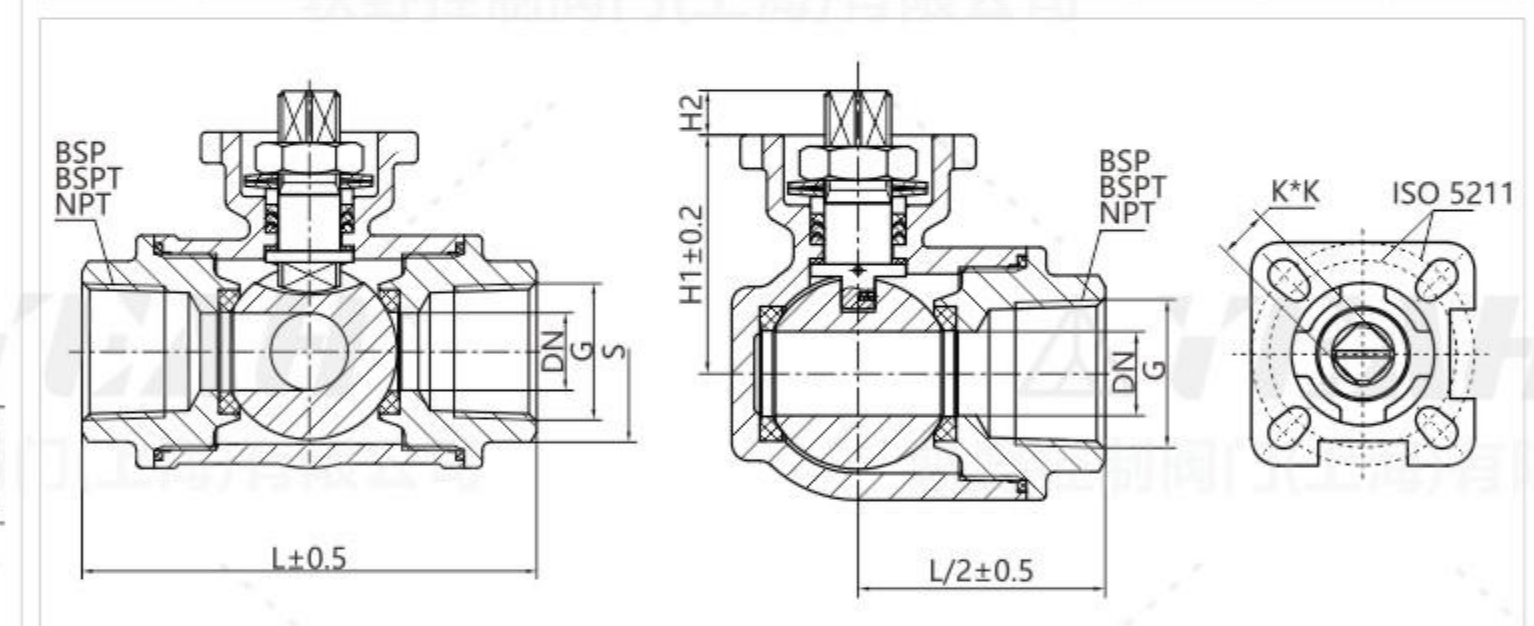

Q14(5)F-1000WOG

SIZE	DN	d	L	G	S(六角对边)	H1	H2	K*K	ISO5211
1/4"	8	10	70	1/4"	24	35	9	9	F03/F04
3/8"	10	12	70	3/8"	24	35	9	9	F03/F04
1/2"	15	12	72	1/2"	24	36	9	9	F03/F04
3/4"	20	15	80	3/4"	30	37	9	9	F03/F04
1"	25	20	87	1"	38	48	12	11	F04/F05
1 1/4"	32	25	112	1 1/4"	48	58	12	11	F04/F05
1 1/2"	40	32	130	1 1/2"	55	70	15	14	F05/F07
2"	50	38	143	2"	67	78	15	14	F05/F07
2 1/2"	65	48	172	2 1/2"	85	100	18	17	F07/F10
3"	80	65	235	3"	99	112	18	17	F07/F10

